



# 深圳市今诚电子有限公司

## 选型手册



公司拥有先进的生产设备、高精度的检测仪器、最前沿产品的研发能力，并汇集了来自本行业领先地位的著名日资和台资企业的管理人员、经验丰富的产品开发（EN）人员、质量管理（QC）人员及熟练的操作人员。严谨的工作作风，更好地满足顾客的需要，确保给客户“零缺陷”的产品，为推进电感行业的发展与进步作出了重大贡献。产品广泛应用于液晶显示屏、笔记本计算机、手机、数码相机、汽车电子、小型设备、仪器仪表、医疗设备、音响、LED灯等。一直以高质量高性能的产品，赢得各界客户的好评。

绕线功率电感



磁胶功率电感



高频绕线电感

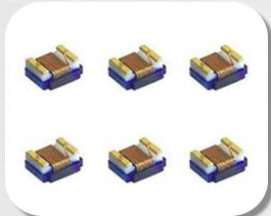

一体成型电感



插件电感



组装式大电流电感



磁环电感



绕线功率电感系列:

CKD 系列



1.机械尺寸 Mechanical: (UNIT: mm)

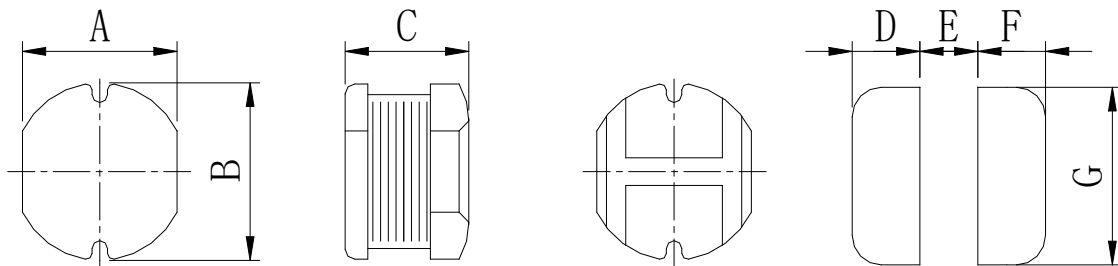

| 型号     | A (mm)  | B (mm)   | C (mm)  | D (mm) | E (mm) | F (mm) | G (mm) |
|--------|---------|----------|---------|--------|--------|--------|--------|
| CKD32  | 3.0±0.3 | 3.5±0.3  | 2.1±0.2 | 1.25   | 1.0    | 1.25   | 3.0    |
| CKD43  | 4.0±0.3 | 4.5±0.3  | 3.2±0.3 | 1.75   | 1.5    | 1.75   | 4.0    |
| CKD54  | 5.2±0.3 | 5.8±0.3  | 4.5±0.4 | 2.1    | 1.6    | 2.1    | 5.2    |
| CKD75  | 7.0±0.3 | 7.8±0.3  | 5.0±0.5 | 3.0    | 2.0    | 3.0    | 7.0    |
| CKD105 | 9.0±0.3 | 10.0±0.3 | 5.4±0.5 | 3.75   | 2.5    | 3.75   | 9.5    |

2) 包装 (编带装) 尺寸:

13" 盘

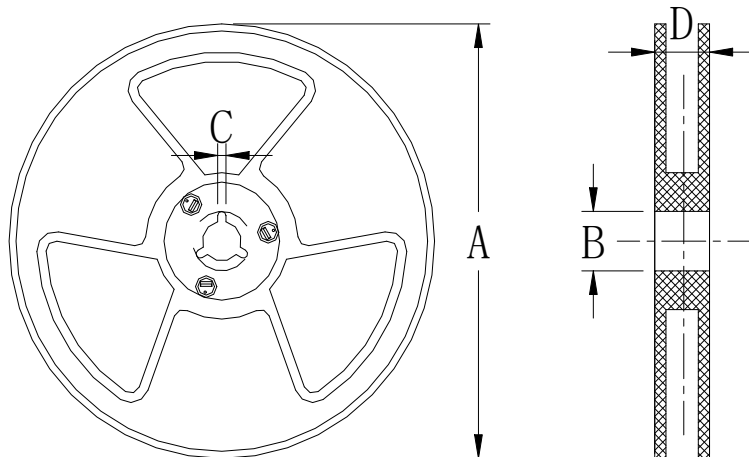

| PART No.   | NOMINAL<br>INDUCTANCE (uH) | DCR<br>( $\Omega$ )MAX | IDC<br>(A)MAX |
|------------|----------------------------|------------------------|---------------|
| CKD32-1R0M | 1.0                        | 48.10m                 | 2.00          |
| CKD32-1R8M | 1.8                        | 56.00m                 | 1.80          |
| CKD32-2R2M | 2.2                        | 72.80m                 | 1.40          |
| CKD32-2R7M | 2.7                        | 98.00m                 | 1.30          |
| CKD32-3R3M | 3.3                        | 108.55m                | 1.25          |
| CKD32-3R9M | 3.9                        | 148.20m                | 1.20          |
| CKD32-4R7M | 4.7                        | 172.90m                | 1.10          |
| CKD32-5R6M | 5.6                        | 192.40m                | 900m          |
| CKD32-6R8M | 6.8                        | 219.44m                | 850m          |
| CKD32-8R2M | 8.2                        | 247.00m                | 800m          |
| CKD32-100K | 10                         | 286.00m                | 730m          |
| CKD32-120K | 12                         | 325.00m                | 620m          |
| CKD32-150K | 15                         | 468.00m                | 600m          |
| CKD32-180K | 18                         | 546.00m                | 530m          |
| CKD32-220K | 22                         | 611.00m                | 500m          |
| CKD32-270K | 27                         | 680.00m                | 420m          |
| CKD32-330K | 33                         | 962.00m                | 400m          |
| CKD32-390K | 39                         | 1.05                   | 360m          |
| CKD32-470K | 47                         | 1.20                   | 340m          |
| CKD32-560K | 56                         | 1.53                   | 320m          |
| CKD32-680K | 68                         | 1.76                   | 300m          |
| CKD32-820K | 82                         | 2.39                   | 280m          |
| CKD32-101K | 100                        | 2.67                   | 250m          |
| CKD32-121K | 120                        | 3.72                   | 200m          |
| CKD32-151K | 150                        | 4.29                   | 190m          |
| CKD32-181K | 180                        | 4.81                   | 170m          |
| CKD32-221K | 220                        | 6.63                   | 160m          |
| CKD32-271K | 270                        | 7.80                   | 130m          |
| CKD32-331K | 330                        | 9.49                   | 125m          |
| CKD32-391K | 390                        | 10.53                  | 120m          |
| CKD32-471K | 470                        | 12.05                  | 90m           |
| CKD32-561K | 560                        | 13.26                  | 80m           |
| CKD32-681K | 680                        | 18.20                  | 70m           |
| CKD32-821K | 820                        | 23.40                  | 60m           |

※ 测试条件：L $\leq$ 8.2uH 测试频率 100KHz / 0.25V, (M $\pm$ 20%);

L>8.2uH 测试频率 1KHz / 0.25V, (K $\pm$ 10%);

※ 测试仪表：HP4291B、502BC、CH1062。

| PART No.   | NOMINAL<br>INDUCTANCE (uH) | DCR<br>(Ω)MAX | IDC<br>(A)MAX |
|------------|----------------------------|---------------|---------------|
| CKD43-1R0M | 1.0                        | 20.00m        | 2.60          |
| CKD43-2R2M | 2.2                        | 42.00m        | 2.30          |
| CKD43-3R3M | 3.3                        | 51.00m        | 2.10          |
| CKD43-3R9M | 3.9                        | 72.80m        | 1.90          |
| CKD43-4R7M | 4.7                        | 76.00m        | 1.60          |
| CKD43-5R6M | 5.6                        | 83.00m        | 1.45          |
| CKD43-6R8M | 6.8                        | 100.00m       | 1.35          |
| CKD43-8R2M | 8.2                        | 120.00m       | 1.30          |
| CKD43-100K | 10                         | 150.00m       | 1.00          |
| CKD43-120K | 12                         | 155.00m       | 900m          |
| CKD43-150K | 15                         | 195.00m       | 800m          |
| CKD43-180K | 18                         | 230.00m       | 700m          |
| CKD43-220K | 22                         | 270.00m       | 600m          |
| CKD43-270K | 27                         | 310.00m       | 550m          |
| CKD43-330K | 33                         | 345.00m       | 500m          |
| CKD43-390K | 39                         | 400.00m       | 480m          |
| CKD43-470K | 47                         | 525.00m       | 400m          |
| CKD43-560K | 56                         | 595.00m       | 380m          |
| CKD43-680K | 68                         | 740.00m       | 330m          |
| CKD43-820K | 82                         | 880.00m       | 290m          |
| CKD43-101K | 100                        | 1.20          | 260m          |
| CKD43-121K | 120                        | 1.25          | 240m          |
| CKD43-151K | 150                        | 1.60          | 220m          |
| CKD43-181K | 180                        | 2.00          | 190m          |
| CKD43-221K | 220                        | 2.35          | 180m          |
| CKD43-271K | 270                        | 3.25          | 160m          |
| CKD43-331K | 330                        | 3.55          | 150m          |
| CKD43-391K | 390                        | 4.20          | 130m          |
| CKD43-471K | 470                        | 4.90          | 120m          |
| CKD43-561K | 560                        | 6.50          | 100m          |
| CKD43-681K | 680                        | 8.30          | 90m           |

※ 测试条件:  $L \leq 8.2\mu\text{H}$  测试频率 100KHz / 0.25V, (M  $\pm$  20%);

$L > 8.2\mu\text{H}$  测试频率 1KHz / 0.25V, (K  $\pm$  10%);

※ 测试仪表: HP4291B、502BC、CH1062。

| PART No.   | NOMINAL<br>INDUCTANCE (uH) | DCR<br>( $\Omega$ )MAX | IDC<br>(A)MAX |
|------------|----------------------------|------------------------|---------------|
| CKD54-1R2N | 1.2                        | 13.0m                  | 5.4           |
| CKD54-1R5M | 1.5                        | 16.9m                  | 4.7           |
| CKD54-1R8M | 1.8                        | 19.5m                  | 4.5           |
| CKD54-2R2M | 2.2                        | 22.1m                  | 4             |
| CKD54-3R3M | 3.3                        | 31.2m                  | 3.7           |
| CKD54-3R9M | 3.9                        | 36.4m                  | 3.2           |
| CKD54-4R7M | 4.7                        | 52.0m                  | 3.1           |
| CKD54-5R6M | 5.6                        | 54.6m                  | 2.8           |
| CKD54-6R8M | 6.8                        | 60.0m                  | 2.4           |
| CKD54-8R2M | 8.2                        | 65.0m                  | 2             |
| CKD54-100K | 10                         | 76.0m                  | 1.42          |
| CKD54-120K | 12                         | 85.0m                  | 1.38          |
| CKD54-150K | 15                         | 105.0m                 | 1.28          |
| CKD54-180K | 18                         | 125.0m                 | 1.22          |
| CKD54-220K | 22                         | 150.0m                 | 1.1           |
| CKD54-270K | 27                         | 188.0m                 | 0.95          |
| CKD54-330K | 33                         | 215.0m                 | 0.86          |
| CKD54-390K | 39                         | 263.0m                 | 0.78          |
| CKD54-470K | 47                         | 355.0m                 | 0.71          |
| CKD54-560K | 56                         | 377.0m                 | 0.66          |
| CKD54-680K | 68                         | 390.0m                 | 0.6           |
| CKD54-820K | 82                         | 416.0m                 | 0.57          |
| CKD54-101K | 100                        | 611.0m                 | 0.51          |
| CKD54-121K | 120                        | 754.0m                 | 0.47          |
| CKD54-151K | 150                        | 845.0m                 | 0.38          |
| CKD54-181K | 180                        | 1.04                   | 0.36          |
| CKD54-221K | 220                        | 1.45                   | 0.34          |
| CKD54-271K | 270                        | 1.51                   | 0.31          |
| CKD54-331K | 330                        | 1.76                   | 0.28          |
| CKD54-391K | 390                        | 2.08                   | 0.26          |
| CKD54-471K | 470                        | 2.99                   | 0.24          |
| CKD54-561K | 560                        | 3.12                   | 0.22          |
| CKD54-681K | 680                        | 3.9                    | 0.2           |
| CKD54-821K | 820                        | 5.2                    | 0.19          |

测试条件:(原手工测试  $L \leq 8.2\mu\text{H}$  用 100KHz / 0.25V;  $L > 8.2\mu\text{H}$  测试频率 1KHz / 0.25V.)

现自动测包  $L \leq 10\mu\text{H}$ , 用 2MHz/0.25V;  $10\mu\text{H} < L \leq 100\mu\text{H}$ , 用 1MHz/0.25V;

$L > 100\mu\text{H}$ , 用 200KHz/0.25V。

| PART No.   | NOMINAL<br>INDUCTANCE (uH) | DCR<br>(Ω)MAX | IDC<br>(A)MAX |
|------------|----------------------------|---------------|---------------|
| CKD75-1R0N | 1.0                        | 13.00m        | 5.20          |
| CKD75-2R2M | 2.2                        | 14.00m        | 5.00          |
| CKD75-2R7M | 2.7                        | 16.90m        | 4.60          |
| CKD75-3R3M | 3.3                        | 19.50m        | 4.00          |
| CKD75-3R9M | 3.9                        | 23.40m        | 4.00          |
| CKD75-4R7M | 4.7                        | 26.00m        | 3.80          |
| CKD75-5R6M | 5.6                        | 27.30m        | 3.10          |
| CKD75-6R8M | 6.8                        | 32.50m        | 2.80          |
| CKD75-8R2M | 8.2                        | 39.00m        | 2.52          |
| CKD75-100K | 10                         | 41.60m        | 2.31          |
| CKD75-120K | 12                         | 49.40m        | 2.00          |
| CKD75-150K | 15                         | 71.50m        | 1.81          |
| CKD75-180K | 18                         | 84.50m        | 1.59          |
| CKD75-220K | 22                         | 91.00m        | 1.50          |
| CKD75-270K | 27                         | 106.60m       | 1.28          |
| CKD75-330K | 33                         | 119.60m       | 1.20          |
| CKD75-390K | 39                         | 149.50m       | 1.08          |
| CKD75-470K | 47                         | 175.50m       | 1.05          |
| CKD75-560K | 56                         | 208.00m       | 930m          |
| CKD75-680K | 68                         | 234.00m       | 830m          |
| CKD75-820K | 82                         | 273.00m       | 780m          |
| CKD75-101K | 100                        | 325.00m       | 730m          |
| CKD75-121K | 120                        | 390.00m       | 650m          |
| CKD75-151K | 150                        | 520.00m       | 580m          |
| CKD75-181K | 180                        | 598.00m       | 510m          |
| CKD75-221K | 220                        | 793.00m       | 480m          |
| CKD75-271K | 270                        | 884.00m       | 400m          |
| CKD75-331K | 330                        | 1.13          | 390m          |
| CKD75-391K | 390                        | 1.30          | 350m          |
| CKD75-471K | 470                        | 1.68          | 330m          |
| CKD75-561K | 560                        | 1.90          | 300m          |
| CKD75-681K | 680                        | 2.47          | 270m          |
| CKD75-821K | 820                        | 2.86          | 250m          |

※ 测试条件：L≤1.0uH 测试频率 100KHz / 0.25V, (N±30%)；

L≤8.2uH 测试频率 100KHz / 0.25V, (M±20%)；

L>8.2uH 测试频率 1KHz / 0.25V, (K±10%)；

※ 测试仪表：HP4291B、502BC、CH1062。

| PART No.    | NOMINAL<br>INDUCTANCE (uH) | DCR<br>(Ω)MAX | IDC<br>(A)MAX |
|-------------|----------------------------|---------------|---------------|
| CKD105-1R0M | 1.0                        | 8.45m         | 8.00          |
| CKD105-1R4M | 1.4                        | 13.78m        | 6.80          |
| CKD105-1R5M | 1.5                        | 13.78m        | 6.80          |
| CKD105-1R8M | 1.8                        | 15.60m        | 6.50          |
| CKD105-2R7M | 2.7                        | 17.81m        | 5.50          |
| CKD105-3R3M | 3.3                        | 19.50m        | 5.00          |
| CKD105-4R7M | 4.7                        | 22.10m        | 4.60          |
| CKD105-5R6M | 5.6                        | 23.79m        | 4.00          |
| CKD105-6R8M | 6.8                        | 26.00m        | 3.60          |
| CKD105-8R2M | 8.2                        | 31.20m        | 3.20          |
| CKD105-100K | 10                         | 34.45m        | 2.58          |
| CKD105-120K | 12                         | 40.30m        | 2.44          |
| CKD105-150K | 15                         | 45.50m        | 2.26          |
| CKD105-180K | 18                         | 48.49m        | 2.13          |
| CKD105-220K | 22                         | 70.20m        | 1.93          |
| CKD105-270K | 27                         | 84.11m        | 1.74          |
| CKD105-330K | 33                         | 92.30m        | 1.46          |
| CKD105-390K | 39                         | 124.80m       | 1.36          |
| CKD105-470K | 47                         | 135.20m       | 1.26          |
| CKD105-560K | 56                         | 158.60m       | 1.15          |
| CKD105-680K | 68                         | 200.20m       | 1.10          |
| CKD105-820K | 82                         | 230.10m       | 980m          |
| CKD105-101K | 100                        | 260.00m       | 950m          |
| CKD105-121K | 120                        | 351.00m       | 870m          |
| CKD105-151K | 150                        | 403.00m       | 740m          |
| CKD105-181K | 180                        | 494.00m       | 700m          |
| CKD105-221K | 220                        | 572.00m       | 650m          |
| CKD105-271K | 270                        | 728.00m       | 540m          |
| CKD105-331K | 330                        | 845.00m       | 500m          |
| CKD105-391K | 390                        | 1.04          | 460m          |
| CKD105-471K | 470                        | 1.18          | 400m          |
| CKD105-561K | 560                        | 1.42          | 300m          |
| CKD105-681K | 680                        | 1.99          | 280m          |
| CKD105-821K | 820                        | 2.03          | 240m          |

※ 测试条件：L≤8.2uH 测试频率 100KHz / 0.25V, (M±20%)；

L>8.2uH 测试频率 1KHz / 0.25V, (K±10%)；

※ 测试仪表：HP4291B、502BC、CH1062。

# CR 系列

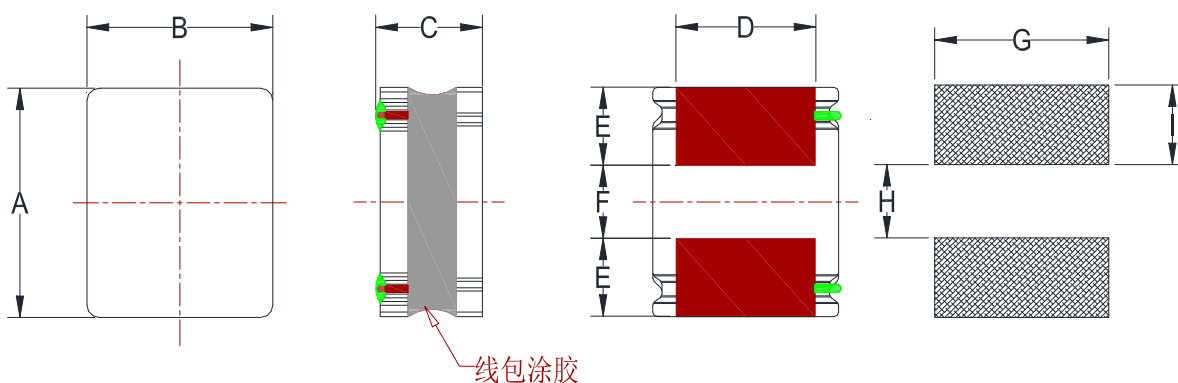
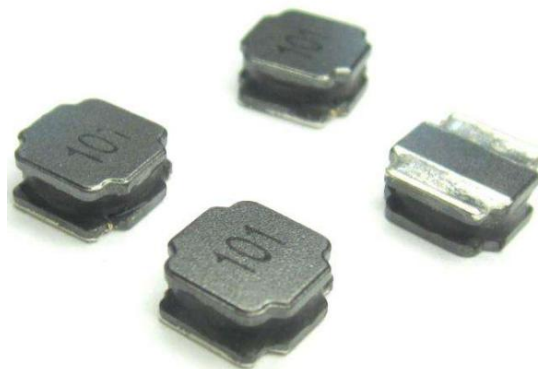

| 型号       | A         | B         | C         | D         | E          | F          | G       | H       | I        |
|----------|-----------|-----------|-----------|-----------|------------|------------|---------|---------|----------|
| CR252012 | 2.5 ± 0.2 | 2.0 ± 0.2 | 1.2 ± 0.1 | 1.5 ± 0.2 | 0.80 ± 0.2 | 0.80 ± 0.2 | 2.0 Ref | 0.8 Ref | 0.85 Ref |
| CR3012   | 3.0 ± 0.2 | 3.0 ± 0.2 | 1.2 Max   | 2.5 ± 0.2 | 0.75 ± 0.2 | 1.5 ± 0.2  | 2.7 Ref | 1.5 Ref | 0.8 Ref  |
| CR3015   | 3.0 ± 0.2 | 3.0 ± 0.2 | 1.5 Max   | 2.5 ± 0.2 | 0.75 ± 0.2 | 1.5 ± 0.2  | 2.7 Ref | 1.5 Ref | 0.8 Ref  |
| CR3018   | 3.0 ± 0.2 | 3.0 ± 0.2 | 1.8 Max   | 2.5 ± 0.2 | 0.75 ± 0.2 | 1.5 ± 0.2  | 2.7 Ref | 1.5 Ref | 0.8 Ref  |
| CR4018   | 4.0 ± 0.2 | 4.0 ± 0.2 | 1.85 Max  | 3.3 ± 0.3 | 1.0 ± 0.2  | 2.0 ± 0.3  | 3.7 Ref | 1.9 Ref | 1.1 Ref  |
| CR4020   | 4.0 ± 0.2 | 4.0 ± 0.2 | 2.1 Max   | 3.3 ± 0.3 | 1.0 ± 0.2  | 2.0 ± 0.3  | 3.7 Ref | 1.9 Ref | 1.1 Ref  |
| CR4030   | 4.0 ± 0.2 | 4.0 ± 0.2 | 3.0 Max   | 3.3 ± 0.3 | 1.0 ± 0.2  | 2.0 ± 0.3  | 3.7 Ref | 1.9 Ref | 1.1 Ref  |
| CR5020   | 5.0 ± 0.2 | 5.0 ± 0.2 | 2.2 Max   | 4.0 ± 0.3 | 1.35 ± 0.2 | 2.3 ± 0.3  | 4.2 Ref | 2.3 Ref | 1.4 Ref  |
| CR5030   | 5.0 ± 0.2 | 5.0 ± 0.2 | 3.0 Max   | 4.0 ± 0.3 | 1.35 ± 0.2 | 2.3 ± 0.3  | 4.2 Ref | 2.3 Ref | 1.4 Ref  |
| CR5040   | 5.0 ± 0.2 | 5.0 ± 0.2 | 4.0 Max   | 4.0 ± 0.3 | 1.35 ± 0.2 | 2.3 ± 0.3  | 4.2 Ref | 2.3 Ref | 1.4 Ref  |
| CR6020   | 6.0 ± 0.3 | 6.0 ± 0.3 | 2.0 Max   | 4.9 ± 0.3 | 1.55 ± 0.3 | 2.9 ± 0.3  | 1.7 Ref | 2.8 Ref | 5.7 Ref  |
| CR6028   | 6.0 ± 0.3 | 6.0 ± 0.3 | 2.8 Max   | 4.9 ± 0.3 | 1.55 ± 0.3 | 2.9 ± 0.3  | 1.7 Ref | 2.8 Ref | 5.7 Ref  |
| CR6040   | 6.0 ± 0.3 | 6.0 ± 0.3 | 4.5 Max   | 4.9 ± 0.3 | 1.55 ± 0.3 | 2.9 ± 0.3  | 1.7 Ref | 2.8 Ref | 5.7 Ref  |
| CR8040   | 8.0 ± 0.3 | 8.0 ± 0.3 | 4.2 Max   | 6.3 ± 0.3 | 2.0 ± 0.3  | 4.0 ± 0.3  | 7.5 Ref | 3.8 Ref | 2.2 Ref  |
| CR8065   | 8.0 ± 0.3 | 8.0 ± 0.3 | 6.4 ± 0.2 | 6.3 ± 0.3 | 2.2 ± 0.3  | 3.7 ± 0.3  | 7.5 Ref | 3.5 Ref | 2.2 Ref  |

| <b>Part Number</b> | <b>Inductance<br/>(<math>\mu</math>H)</b> | <b>Tolerance<br/>(<math>\pm</math>%)</b> | <b>DCR (<math>m\Omega</math>)<br/><math>\pm 25\%</math></b> | <b>Isat (A)</b> | <b>Irise(A)</b>  | <b>Test<br/>Condition</b> |
|--------------------|---|--|---|-----------------|------------------|---------------------------|
| CR252012-R33N      | 0.33                                      | 30                                       | 40  | 3.9             | 2.35             | 100KHz /0.25V             |
| CR252012-R68N      | 0.68                                      | 30                                       | 73  | 3.1             | 1.73             | 100KHz /0.25V             |
| CR252012-1R0N      | 1   | 30                                       | 85  | 3               | 1.58             | 100KHz /0.25V             |
| CR252012-1R5M      | 1.5                                       | 20                                       | 113   | 2.51            | 1.4              | 100KHz /0.25V             |
| CR252012-2R2M      | 2.2                                       | 20                                       | 165   | 2.07            | 1.15             | 100KHz /0.25V             |
| CR252012-3R3M      | 3.3                                       | 20                                       | 200   | 1.8             | 1.04             | 100KHz /0.25V             |
| CR252012-4R7M      | 4.7                                       | 20                                       | 315   | 1.32            | 0.84             | 100KHz /0.25V             |
| CR252012-5R6M      | 5.6                                       | 20                                       | 330   | 1.26            | 0.73             | 100KHz /0.25V             |
| CR252012-6R8M      | 6.8                                       | 20                                       | 447   | 1.1             | 0.69             | 100KHz /0.25V             |
| CR252012-8R2M      | 8.2                                       | 20                                       | 506   | 1.1             | 0.65             | 100KHz /0.25V             |
| CR252012-100M      | 10  | 20                                       | 575   | 0.97            | 0.62             | 100KHz/0.25V              |
| CR252012-150M      | 15  | 20                                       | 900   | 0.68            | 0.4              | 100KHz/0.25V              |
| <b>Part Number</b> | <b>Inductance<br/>(<math>\mu</math>H)</b> | <b>Tolerance<br/>(<math>\pm</math>%)</b> | <b>DCR<br/>(<math>m\Omega</math>) <math>\pm 30\%</math></b> | <b>Isat (A)</b> | <b>Irise (A)</b> | <b>Test<br/>Condition</b> |
| CR3012-R47N        | 0.47                                      | 30                                       | 33  | 2.2             | 2.2              | 100KHz /0.25V             |
| CR3012-R82N        | 0.82                                      | 30                                       | 40  | 2.05            | 2.1              | 100KHz /0.25V             |
| CR3012-1R0N        | 1   | 30                                       | 48  | 1.9             | 2                | 100KHz /0.25V             |
| CR3012-1R5N        | 1.5                                       | 30                                       | 55  | 1.62            | 1.85             | 100KHz /0.25V             |
| CR3012-2R2M        | 2.2                                       | 20                                       | 75  | 1.2             | 1.55             | 100KHz /0.25V             |
| CR3012-3R3M        | 3.3                                       | 20                                       | 100   | 1.05            | 1.35             | 100KHz /0.25V             |
| CR3012-4R7M        | 4.7                                       | 20                                       | 120   | 0.9             | 1.25             | 100KHz /0.25V             |
| CR3012-5R6M        | 5.6                                       | 20                                       | 160   | 0.8             | 1.1              | 100KHz /0.25V             |
| CR3012-6R8M        | 6.8                                       | 20                                       | 190   | 0.75            | 1                | 100KHz /0.25V             |

|             |             |           |             |             |             |                      |
|-------------|-------------|-----------|-------------|-------------|-------------|----------------------|
| CR3012-100M | <u>10</u>   | <u>20</u> | <u>265</u>  | <u>0.6</u>  | <u>0.89</u> | <u>100KHz /0.25V</u> |
| CR3012-150M | <u>15</u>   | <u>20</u> | <u>430</u>  | <u>0.45</u> | <u>0.72</u> | <u>100KHz /0.25V</u> |
| CR3012-220M | <u>22</u>   | <u>20</u> | <u>630</u>  | <u>0.42</u> | <u>0.55</u> | <u>100KHz /0.25V</u> |
| CR3012-270M | <u>27</u>   | <u>20</u> | <u>800</u>  | <u>0.35</u> | <u>0.45</u> | <u>100KHz /0.25V</u> |
| CR3012-330M | <u>33</u>   | <u>20</u> | <u>875</u>  | <u>0.36</u> | <u>0.46</u> | <u>100KHz /0.25V</u> |
| CR3012-470M | <u>47</u>   | <u>20</u> | <u>1450</u> | <u>0.27</u> | <u>0.35</u> | <u>100KHz /0.25V</u> |
| CR3015-R30N | <u>0.3</u>  | <u>30</u> | <u>15</u>   | <u>4.6</u>  | <u>3.5</u>  | <u>1MHz /0.25V</u>   |
| CR3015-R47N | <u>0.47</u> | <u>30</u> | <u>20</u>   | <u>4</u>    | <u>3.5</u>  | <u>100KHz /0.25V</u> |
| CR3015-R56N | <u>0.56</u> | <u>30</u> | <u>20</u>   | <u>3.3</u>  | <u>2.8</u>  | <u>100KHz /0.25V</u> |
| CR3015-1R0N | <u>1</u>    | <u>30</u> | <u>30</u>   | <u>2.32</u> | <u>2.1</u>  | <u>100KHz /0.25V</u> |
| CR3015-1R5N | <u>1.5</u>  | <u>30</u> | <u>50</u>   | <u>2</u>    | <u>1.7</u>  | <u>100KHz /0.25V</u> |
| CR3015-1R8N | <u>1.8</u>  | <u>30</u> | <u>55</u>   | <u>1.75</u> | <u>1.65</u> | <u>100KHz /0.25V</u> |
| CR3015-2R2N | <u>2.2</u>  | <u>30</u> | <u>60</u>   | <u>1.6</u>  | <u>1.6</u>  | <u>100KHz /0.25V</u> |
| CR3015-2R7N | <u>2.7</u>  | <u>30</u> | <u>70</u>   | <u>1.52</u> | <u>1.5</u>  | <u>100KHz /0.25V</u> |
| CR3015-3R3M | <u>3.3</u>  | <u>20</u> | <u>80</u>   | <u>1.32</u> | <u>1.36</u> | <u>100KHz /0.25V</u> |
| CR3015-3R9M | <u>3.9</u>  | <u>20</u> | <u>108</u>  | <u>1.2</u>  | <u>1.1</u>  | <u>100KHz /0.25V</u> |
| CR3015-4R7M | <u>4.7</u>  | <u>20</u> | <u>125</u>  | <u>1.1</u>  | <u>1.09</u> | <u>100KHz /0.25V</u> |
| CR3015-5R6M | <u>5.6</u>  | <u>20</u> | <u>170</u>  | <u>1.05</u> | <u>1</u>    | <u>100KHz /0.25V</u> |
| CR3015-6R8M | <u>6.8</u>  | <u>20</u> | <u>200</u>  | <u>0.85</u> | <u>0.85</u> | <u>100KHz /0.25V</u> |
| CR3015-8R2M | <u>8.2</u>  | <u>20</u> | <u>230</u>  | <u>0.8</u>  | <u>0.75</u> | <u>100KHz /0.25V</u> |
| CR3015-100M | <u>10</u>   | <u>20</u> | <u>250</u>  | <u>0.72</u> | <u>0.77</u> | <u>100KHz /0.25V</u> |
| CR3015-120M | <u>12</u>   | <u>20</u> | <u>288</u>  | <u>0.7</u>  | <u>0.68</u> | <u>100KHz /0.25V</u> |
| CR3015-150M | <u>15</u>   | <u>20</u> | <u>350</u>  | <u>0.66</u> | <u>0.65</u> | <u>100KHz /0.25V</u> |
| CR3015-180M | <u>18</u>   | <u>20</u> | <u>430</u>  | <u>0.56</u> | <u>0.59</u> | <u>100KHz /0.25V</u> |
| CR3015-220M | <u>22</u>   | <u>20</u> | <u>460</u>  | <u>0.52</u> | <u>0.57</u> | <u>100KHz /0.25V</u> |
| CR3015-270M | <u>27</u>   | <u>20</u> | <u>630</u>  | <u>0.48</u> | <u>0.46</u> | <u>100KHz /0.25V</u> |
| CR3015-330M | <u>33</u>   | <u>20</u> | <u>780</u>  | <u>0.44</u> | <u>0.42</u> | <u>100KHz /0.25V</u> |
| CR3015-470M | <u>47</u>   | <u>20</u> | <u>1200</u> | <u>0.35</u> | <u>0.32</u> | <u>100KHz /0.25V</u> |
| CR3018-1R0N | <u>1</u>    | <u>30</u> | <u>32</u>   | <u>2.8</u>  | <u>2.4</u>  | <u>1MHz /0.25V</u>   |
| CR3018-1R5N | <u>1.5</u>  | <u>30</u> | <u>38</u>   | <u>2.7</u>  | <u>1.85</u> | <u>1MHz /0.25V</u>   |
| CR3018-2R2N | <u>2.2</u>  | <u>30</u> | <u>55</u>   | <u>2.05</u> | <u>1.7</u>  | <u>1MHz /0.25V</u>   |
| CR3018-3R3M | <u>3.3</u>  | <u>20</u> | <u>79</u>   | <u>1.7</u>  | <u>1.45</u> | <u>1MHz /0.25V</u>   |
| CR3018-4R7M | <u>4.7</u>  | <u>20</u> | <u>114</u>  | <u>1.4</u>  | <u>1.15</u> | <u>1MHz /0.25V</u>   |
| CR3018-5R2M | <u>5.2</u>  | <u>20</u> | <u>122</u>  | <u>1.35</u> | <u>0.1</u>  | <u>1MHz /0.25V</u>   |
| CR3018-6R2M | <u>6.2</u>  | <u>20</u> | <u>140</u>  | <u>1.25</u> | <u>0.9</u>  | <u>1MHz /0.25V</u>   |
| CR3018-100M | <u>10</u>   | <u>20</u> | <u>285</u>  | <u>1</u>    | <u>0.8</u>  | <u>1MHz /0.25V</u>   |

|             |      |    |      |      |      |               |
|-------------|------|----|------|------|------|---------------|
| CR3018-150M | 15   | 20 | 344  | 0.8  | 0.7  | 1MHz /0.25V   |
| CR3018-220M | 22   | 20 | 545  | 0.62 | 0.6  | 1MHz /0.25V   |
| CR4018-R56N | 0.56 | 30 | 18   | 6.5  | 3.5  | 100KHz /0.25V |
| CR4018-1R0N | 1    | 30 | 23   | 4.5  | 2.5  | 100KHz /0.25V |
| CR4018-1R2N | 1.2  | 30 | 28   | 4.3  | 2.4  | 100KHz /0.25V |
| CR4018-1R5N | 1.5  | 30 | 33   | 3.35 | 2.34 | 100KHz /0.25V |
| CR4018-1R8N | 1.8  | 30 | 44   | 3    | 2    | 100KHz /0.25V |
| CR4018-2R2M | 2.2  | 20 | 44   | 2.7  | 2    | 100KHz /0.25V |
| CR4018-3R3M | 3.3  | 20 | 70   | 2.45 | 1.9  | 100KHz /0.25V |
| CR4018-4R7M | 4.7  | 20 | 90   | 1.7  | 1.7  | 100KHz /0.25V |
| CR4018-5R6M | 5.6  | 20 | 103  | 1.6  | 1.5  | 100KHz /0.25V |
| CR4018-6R8M | 6.8  | 20 | 124  | 1.45 | 1.3  | 100KHz /0.25V |
| CR4018-8R2M | 8.2  | 20 | 180  | 1.4  | 1.15 | 100KHz /0.25V |
| CR4018-100M | 10   | 20 | 200  | 1.3  | 1.1  | 100KHz /0.25V |
| CR4018-120M | 12   | 20 | 230  | 1.15 | 0.95 | 100KHz /0.25V |
| CR4018-150M | 15   | 20 | 268  | 0.94 | 0.92 | 100KHz /0.25V |
| CR4018-180M | 18   | 20 | 320  | 0.86 | 0.61 | 100KHz /0.25V |
| CR4018-220M | 22   | 20 | 390  | 0.8  | 0.8  | 100KHz /0.25V |
| CR4018-330M | 33   | 20 | 560  | 0.65 | 0.6  | 100KHz /0.25V |
| CR4018-470M | 47   | 20 | 850  | 0.57 | 0.5  | 100KHz /0.25V |
| CR4020-R33N | 0.33 | 30 | 13   | 7.5  | 3.3  | 100KHz /0.25V |
| CR4020-R47N | 0.47 | 30 | 18   | 7.5  | 3.3  | 100KHz /0.25V |
| CR4020-1R0N | 1    | 30 | 28   | 5.1  | 2.15 | 100KHz /0.25V |
| CR4020-1R2N | 1.2  | 30 | 29   | 4.7  | 2.1  | 100KHz /0.25V |
| CR4020-1R5N | 1.5  | 30 | 35   | 4.45 | 1.98 | 100KHz /0.25V |
| CR4020-1R8N | 1.8  | 30 | 45   | 4    | 1.9  | 100KHz /0.25V |
| CR4020-2R2M | 2.2  | 20 | 45   | 3.4  | 1.85 | 100KHz /0.25V |
| CR4020-3R3M | 3.3  | 20 | 70   | 3.2  | 1.4  | 100KHz /0.25V |
| CR4020-4R7M | 4.7  | 20 | 80   | 2.35 | 1.34 | 100KHz /0.25V |
| CR4020-5R6M | 5.6  | 20 | 95   | 2.2  | 1.22 | 100KHz /0.25V |
| CR4020-6R8M | 6.8  | 20 | 125  | 2    | 1.04 | 100KHz /0.25V |
| CR4020-8R2M | 8.2  | 20 | 150  | 1.75 | 1    | 100KHz /0.25V |
| CR4020-100M | 10   | 20 | 165  | 1.6  | 0.9  | 100KHz /0.25V |
| CR4020-120M | 12   | 20 | 175  | 1.5  | 0.88 | 100KHz /0.25V |
| CR4020-150M | 15   | 20 | 230  | 1.35 | 0.77 | 100KHz /0.25V |
| CR4020-220M | 22   | 20 | 350  | 1.05 | 0.62 | 100KHz /0.25V |
| CR4020-330M | 33   | 20 | 500  | 0.85 | 0.49 | 100KHz /0.25V |
| CR4020-470M | 47   | 20 | 710  | 0.74 | 0.44 | 100KHz /0.25V |
| CR4020-560M | 56   | 20 | 800  | 0.68 | 0.4  | 100KHz /0.25V |
| CR4020-680M | 68   | 20 | 1250 | 0.6  | 0.35 | 100KHz /0.25V |

|             |      |    |      |      |      |               |
|-------------|------|----|------|------|------|---------------|
| CR4030-R47N | 0.47 | 30 | 11   | 7.5  | 3.5  | 100kHz /0.25V |
| CR4030-R56N | 0.56 | 30 | 14   | 6    | 4    | 100kHz /0.25V |
| CR4030-1R0N | 1    | 30 | 15   | 5.9  | 3.4  | 100kHz /0.25V |
| CR4030-1R5N | 1.5  | 30 | 25   | 4.85 | 3.3  | 100kHz /0.25V |
| CR4030-1R8N | 1.8  | 30 | 30   | 4.25 | 3.2  | 100kHz /0.25V |
| CR4030-2R2M | 2.2  | 20 | 35   | 4.1  | 2.95 | 100kHz /0.25V |
| CR4030-3R3M | 3.3  | 20 | 40   | 3.3  | 2.4  | 100kHz /0.25V |
| CR4030-3R6M | 3.6  | 20 | 53   | 3.1  | 2.3  | 100kHz /0.25V |
| CR4030-3R9M | 3.9  | 20 | 57   | 3    | 2.1  | 100kHz /0.25V |
| CR4030-4R7M | 4.7  | 20 | 60   | 2.9  | 2    | 100kHz /0.25V |
| CR4030-5R6M | 5.6  | 20 | 70   | 2.75 | 1.95 | 100kHz /0.25V |
| CR4030-6R8M | 6.8  | 20 | 75   | 2.6  | 1.7  | 100kHz /0.25V |
| CR4030-7R5M | 7.5  | 20 | 90   | 2.2  | 1.65 | 100kHz /0.25V |
| CR4030-8R2M | 8.2  | 20 | 100  | 2.1  | 1.6  | 100kHz /0.25V |
| CR4030-100M | 10   | 20 | 115  | 1.95 | 1.5  | 100kHz /0.25V |
| CR4030-120M | 12   | 20 | 140  | 1.7  | 1.35 | 100kHz /0.25V |
| CR4030-150M | 15   | 20 | 190  | 1.65 | 1.15 | 100kHz /0.25V |
| CR4030-180M | 18   | 20 | 215  | 1.4  | 1.1  | 100kHz /0.25V |
| CR4030-220M | 22   | 20 | 225  | 1.3  | 1    | 100kHz /0.25V |
| CR4030-330M | 33   | 20 | 330  | 1.1  | 0.84 | 100kHz /0.25V |
| CR4030-470M | 47   | 20 | 500  | 0.9  | 0.72 | 100kHz /0.25V |
| CR4030-560M | 56   | 20 | 560  | 0.85 | 0.65 | 100kHz /0.25V |
| CR4030-680M | 68   | 20 | 750  | 0.75 | 0.55 | 100kHz /0.25V |
| CR4030-820M | 82   | 20 | 950  | 0.68 | 0.5  | 100kHz /0.25V |
| CR4030-101M | 100  | 20 | 1150 | 0.6  | 0.45 | 100kHz /0.25V |
| CR4030-151M | 150  | 20 | 2350 | 0.5  | 0.35 | 100kHz /0.25V |
| CR4030-181M | 180  | 20 | 2500 | 0.4  | 0.35 | 100kHz /0.25V |
| CR4030-221M | 220  | 20 | 3000 | 0.4  | 0.3  | 100K/0.25V    |
| CR4030-331M | 330  | 20 | 4400 | 0.3  | 0.23 | 100K/0.25V    |
| CR4030-471M | 470  | 20 | 5500 | 0.3  | 0.2  | 100K/0.25V    |
| CR5020-R22N | 0.22 | 30 | 11   | 6    | 5    | 100KHz /0.25V |
| CR5020-R24N | 0.24 | 30 | 11   | 6    | 5    | 100KHz /0.25V |
| CR5020-R33N | 0.33 | 30 | 15   | 7.5  | 3.95 | 100KHz /0.25V |
| CR5020-R47N | 0.47 | 30 | 15   | 4.85 | 3.95 | 100KHz /0.25V |
| CR5020-1R0N | 1    | 30 | 20   | 4.33 | 3.7  | 100KHz /0.25V |
| CR5020-1R2N | 1.2  | 30 | 25   | 4.2  | 3.5  | 100KHz /0.25V |
| CR5020-1R5N | 1.5  | 30 | 26   | 4.1  | 3.2  | 100KHz /0.25V |
| CR5020-1R8N | 1.8  | 30 | 30   | 4    | 3    | 100KHz /0.25V |
| CR5020-2R2N | 2.2  | 30 | 38   | 3.85 | 2.9  | 100KHz /0.25V |
| CR5020-2R7N | 2.7  | 30 | 45   | 3.5  | 2.4  | 100KHz /0.25V |

|               |      |       |      |      |      |               |
|---------------|------|-------|------|------|------|---------------|
| CR5020-3R3N   | 3.3  | 30    | 46   | 3.25 | 2.4  | 100KHz /0.25V |
| CR5020-3R6N   | 3.6  | 30    | 48   | 2.9  | 2.3  | 100KHz /0.25V |
| CR5020-3R9N   | 3.9  | 30    | 50   | 2.9  | 2.15 | 100KHz /0.25V |
| CR5020-4R7M   | 4.7  | 20    | 65   | 2.4  | 2.05 | 100KHz /0.25V |
| CR5020-5R6M   | 5.6  | 20    | 72   | 2.3  | 1.85 | 100KHz /0.25V |
| CR5020-6R8M   | 6.8  | 20    | 92   | 2.1  | 1.7  | 100KHz /0.25V |
| CR5020-8R2M   | 8.2  | 20    | 100  | 1.9  | 1.6  | 100KHz /0.25V |
| CR5020-100M   | 10   | 20    | 125  | 1.8  | 1.5  | 100KHz /0.25V |
| CR5020-150M   | 15   | 20    | 180  | 1.44 | 1.25 | 100KHz /0.25V |
| CR5020-220M   | 22   | 20    | 250  | 1.18 | 1.05 | 100KHz /0.25V |
| CR5020-270M   | 27   | 20    | 300  | 1.1  | 1    | 100KHz /0.25V |
| CR5020-330M   | 33   | 20    | 370  | 0.97 | 0.83 | 100KHz /0.25V |
| CR5020-470M   | 47   | 20    | 560  | 0.81 | 0.7  | 100KHz /0.25V |
| CR5020-680M   | 68   | 20    | 850  | 0.7  | 0.53 | 100KHz /0.25V |
| CR5020-820M   | 82   | 20    | 950  | 0.65 | 0.5  | 100KHz /0.25V |
| CR5020-101M   | 100  | 20    | 1100 | 0.57 | 0.43 | 100KHz /0.25V |
| CR5020-151M   | 150  | 20    | 1500 | 0.41 | 0.4  | 100KHz /0.25V |
| CR5020-221M   | 220  | 20    | 2230 | 0.35 | 0.3  | 100KHz /0.25V |
| CR5030-R47N   | 0.47 | 30    | 10   | 9    | 5    | 100KHz /0.25V |
| CR5030-1R0N   | 1    | 30    | 15   | 6.65 | 4    | 100KHz /0.25V |
| CR5030-1R5N   | 1.5  | 30    | 16   | 6    | 3.9  | 100KHz /0.25V |
| CR5030-2R2M   | 2.2  | 20    | 23   | 4.2  | 3.5  | 100KHz /0.25V |
| CR5030-3R3M   | 3.3  | 20    | 30   | 3.6  | 3    | 100KHz /0.25V |
| CR5030-4R7M   | 4.7  | 20    | 35   | 3.1  | 2.6  | 100KHz /0.25V |
| CR5030-6R8M   | 6.8  | 20    | 52   | 2.5  | 2.3  | 100KHz /0.25V |
| CR5030-100M   | 10   | 20    | 70   | 2.1  | 1.7  | 100KHz /0.25V |
| CR5030-150M   | 15   | 20    | 125  | 1.6  | 1.4  | 100KHz /0.25V |
| CR5030-220M   | 22   | 20    | 180  | 1.4  | 1.05 | 100KHz /0.25V |
| CR5030-270M   | 27   | 20    | 190  | 1.3  | 0.9  | 100KHz /0.25V |
| CR5030-330M   | 33   | 20    | 225  | 1.15 | 0.8  | 100KHz /0.25V |
| CR5030-470M   | 47   | 20    | 325  | 0.95 | 0.7  | 100KHz /0.25V |
| CR5030-560M   | 56   | 20    | 420  | 0.89 | 0.63 | 100KHz /0.25V |
| CR5030-680M   | 68   | 20    | 475  | 0.85 | 0.68 | 100KHz /0.25V |
| CR5030-101M   | 100  | 20    | 720  | 0.71 | 0.65 | 100KHz /0.25V |
| CR5030-151M   | 150  | 20    | 1050 | 0.6  | 0.55 | 100KHz /0.25V |
| CR5030-221M   | 220  | 20    | 1300 | 0.55 | 0.45 | 100KHz /0.25V |
| CR5040-1R0N/M | 1    | 30/20 | 13   | 7.35 | 4.9  | 100KHz /0.25V |
| CR5040-1R5N   | 1.5  | 30    | 15   | 6.3  | 4.3  | 100KHz /0.25V |
| CR5040-1R8N   | 1.8  | 30    | 18   | 6.1  | 3.9  | 100KHz /0.25V |
| CR5040-2R2N   | 2.2  | 30    | 19   | 4.9  | 3.8  | 100KHz /0.25V |

|               |      |       |     |      |      |               |
|---------------|------|-------|-----|------|------|---------------|
| CR5040-2R7N   | 2.7  | 30    | 22  | 4.3  | 3.6  | 100KHz /0.25V |
| CR5040-3R3N   | 3.3  | 30    | 24  | 3.95 | 3.4  | 100KHz /0.25V |
| CR5040-3R9N   | 3.9  | 30    | 27  | 3.55 | 3.2  | 100KHz /0.25V |
| CR5040-4R7N/M | 4.7  | 30/20 | 30  | 3.5  | 3    | 100KHz /0.25V |
| CR5040-5R6M   | 5.6  | 20    | 33  | 3.2  | 2.8  | 100KHz /0.25V |
| CR5040-6R8M   | 6.8  | 20    | 43  | 2.9  | 2.5  | 100KHz /0.25V |
| CR5040-8R2M   | 8.2  | 20    | 55  | 3    | 2.3  | 100KHz /0.25V |
| CR5040-100M   | 10   | 20    | 64  | 2.35 | 2.1  | 100KHz /0.25V |
| CR5040-150M   | 15   | 20    | 86  | 2    | 2    | 100KHz /0.25V |
| CR5040-220M   | 22   | 20    | 129 | 1.6  | 1.5  | 100KHz /0.25V |
| CR5040-270M   | 27   | 20    | 165 | 1.5  | 1.3  | 100KHz /0.25V |
| CR5040-330M   | 33   | 20    | 188 | 1.3  | 1.2  | 100KHz /0.25V |
| CR5040-390M   | 39   | 20    | 225 | 1.2  | 1.1  | 100KHz /0.25V |
| CR5040-470M   | 47   | 20    | 270 | 1.1  | 1    | 100KHz /0.25V |
| CR5040-560M   | 56   | 20    | 375 | 1    | 0.9  | 100KHz /0.25V |
| CR5040-680M   | 68   | 20    | 400 | 0.9  | 0.8  | 100KHz /0.25V |
| CR5040-101M   | 100  | 20    | 560 | 0.75 | 0.7  | 100KHz /0.25V |
| CR6020-R68N   | 0.68 | 30    | 15  | 7.5  | 3.8  | 100KHz /0.25V |
| CR6020-1R0N   | 1    | 30    | 20  | 4.8  | 3.5  | 100KHz /0.25V |
| CR6020-1R2N   | 1.2  | 30    | 20  | 4.3  | 3.5  | 100KHz /0.25V |
| CR6020-1R5N   | 1.5  | 30    | 25  | 4.3  | 3.2  | 100KHz /0.25V |
| CR6020-2R2N   | 2.2  | 30    | 35  | 3.75 | 2.75 | 100KHz /0.25V |
| CR6020-3R3N   | 3.3  | 30    | 45  | 3.15 | 2.6  | 100KHz /0.25V |
| CR6020-4R7N   | 4.7  | 30    | 58  | 3    | 2    | 100KHz /0.25V |
| CR6020-5R6M   | 5.6  | 20    | 70  | 2.4  | 1.9  | 100KHz /0.25V |
| CR6020-6R8M   | 6.8  | 20    | 85  | 2.2  | 1.8  | 100KHz /0.25V |
| CR6020-100M   | 10   | 20    | 120 | 1.75 | 1.4  | 100KHz /0.25V |
| CR6020-150M   | 15   | 20    | 160 | 1.5  | 1.2  | 100KHz /0.25V |
| CR6020-220M   | 22   | 20    | 240 | 1.25 | 1    | 100KHz /0.25V |
| CR6020-270M   | 27   | 20    | 350 | 1.15 | 0.95 | 100KHz /0.25V |
| CR6020-330M   | 33   | 20    | 400 | 1.1  | 0.9  | 100KHz /0.25V |
| CR6020-470M   | 47   | 20    | 500 | 1    | 0.8  | 100KHz /0.25V |
| CR6020-680M   | 68   | 20    | 815 | 0.8  | 0.68 | 100KHz /0.25V |
| CR6028-1R0N   | 1    | 30    | 12  | 6.7  | 4.6  | 100KHz /0.25V |
| CR6028-1R2N   | 1.2  | 30    | 16  | 6.5  | 4.3  | 100KHz /0.25V |
| CR6028-1R5N   | 1.5  | 30    | 16  | 6    | 4.3  | 100KHz /0.25V |
| CR6028-1R8N   | 1.8  | 30    | 19  | 5.3  | 4.1  | 100KHz /0.25V |
| CR6028-2R2N   | 2.2  | 30    | 20  | 5.1  | 3.75 | 100KHz /0.25V |
| CR6028-3R3N   | 3.3  | 30    | 25  | 3.63 | 3.4  | 100KHz /0.25V |
| CR6028-4R7N   | 4.7  | 30    | 33  | 3    | 3    | 100KHz /0.25V |

|             |      |    |     |      |      |               |
|-------------|------|----|-----|------|------|---------------|
| CR6028-5R6N | 5.6  | 30 | 45  | 2.8  | 2.45 | 100KHz /0.25V |
| CR6028-6R8M | 6.8  | 20 | 56  | 2.6  | 2.4  | 100KHz /0.25V |
| CR6028-8R2M | 8.2  | 20 | 68  | 2.4  | 2.25 | 100KHz /0.25V |
| CR6028-100M | 10   | 20 | 78  | 2.05 | 1.9  | 100KHz /0.25V |
| CR6028-120M | 12   | 20 | 88  | 1.8  | 1.7  | 100KHz /0.25V |
| CR6028-150M | 15   | 20 | 125 | 1.75 | 1.5  | 100KHz /0.25V |
| CR6028-180M | 18   | 20 | 130 | 1.55 | 1.45 | 100KHz /0.25V |
| CR6028-220M | 22   | 20 | 140 | 1.45 | 1.4  | 100KHz /0.25V |
| CR6028-270M | 27   | 20 | 180 | 1.4  | 1.3  | 100KHz /0.25V |
| CR6028-330M | 33   | 20 | 220 | 1.35 | 1.1  | 100KHz /0.25V |
| CR6028-390M | 39   | 20 | 225 | 1.25 | 1.1  | 100KHz /0.25V |
| CR6028-470M | 47   | 20 | 280 | 1.15 | 1.05 | 100KHz /0.25V |
| CR6028-680M | 68   | 20 | 420 | 0.95 | 0.85 | 100KHz /0.25V |
| CR6028-820M | 82   | 20 | 550 | 0.8  | 0.7  | 100KHz /0.25V |
| CR6028-101M | 100  | 20 | 670 | 0.65 | 0.6  | 100KHz /0.25V |
| CR6028-121M | 120  | 20 | 820 | 0.62 | 0.58 | 100KHz /0.25V |
| CR6045-R56N | 0.56 | 30 | 7.5 | 14.5 | 6.2  | 1MH /0.25V    |
| CR6045-1R0N | 1    | 30 | 10  | 9    | 5.1  | 100KHz /0.25V |
| CR6045-1R5N | 1.5  | 30 | 12  | 7.5  | 4.75 | 100KHz /0.25V |
| CR6045-1R8N | 1.8  | 30 | 13  | 7.5  | 4.6  | 100KHz /0.25V |
| CR6045-2R2N | 2.2  | 30 | 13  | 6.5  | 4.6  | 100KHz /0.25V |
| CR6045-3R3N | 3.3  | 30 | 20  | 5.3  | 3.2  | 100KHz /0.25V |
| CR6045-3R9N | 3.9  | 30 | 20  | 4.9  | 3.2  | 100KHz /0.25V |
| CR6045-4R7N | 4.7  | 30 | 24  | 4.5  | 3    | 100KHz /0.25V |
| CR6045-5R6N | 5.6  | 30 | 31  | 3.7  | 2.8  | 100KHz /0.25V |
| CR6045-6R8M | 6.8  | 20 | 33  | 3.3  | 2.7  | 100KHz /0.25V |
| CR6045-8R2M | 8.2  | 20 | 45  | 3.2  | 2.6  | 100KHz /0.25V |
| CR6045-100M | 10   | 20 | 52  | 3    | 2.5  | 100KHz /0.25V |
| CR6045-120M | 12   | 20 | 58  | 2.8  | 2.2  | 100KHz /0.25V |
| CR6045-150M | 15   | 20 | 77  | 2.5  | 1.9  | 100KHz /0.25V |
| CR6045-180M | 18   | 20 | 95  | 2.2  | 1.75 | 100KHz /0.25V |
| CR6045-220M | 22   | 20 | 115 | 2    | 1.5  | 100KHz /0.25V |
| CR6045-270M | 27   | 20 | 120 | 1.9  | 1.48 | 100KHz /0.25V |
| CR6045-330M | 33   | 20 | 150 | 1.6  | 1.45 | 100KHz /0.25V |
| CR6045-390M | 39   | 20 | 180 | 1.5  | 1.25 | 100KHz /0.25V |
| CR6045-470M | 47   | 20 | 220 | 1.4  | 1.2  | 100KHz /0.25V |
| CR6045-560M | 56   | 20 | 260 | 1.3  | 1.1  | 100KHz /0.25V |
| CR6045-680M | 68   | 20 | 290 | 1.2  | 0.9  | 100KHz /0.25V |
| CR6045-820M | 82   | 20 | 355 | 1.1  | 0.85 | 100KHz /0.25V |
| CR6045-101M | 100  | 20 | 430 | 1    | 0.8  | 100KHz /0.25V |

|             |             |           |             |             |             |                      |
|-------------|-------------|-----------|-------------|-------------|-------------|----------------------|
| CR6045-121M | <u>120</u>  | <u>20</u> | <u>530</u>  | <u>0.85</u> | <u>0.75</u> | <u>100KHz /0.25V</u> |
| CR6045-151M | <u>150</u>  | <u>20</u> | <u>760</u>  | <u>0.8</u>  | <u>0.7</u>  | <u>100KHz /0.25V</u> |
| CR6045-181M | <u>180</u>  | <u>20</u> | <u>845</u>  | <u>0.75</u> | <u>0.65</u> | <u>100KHz /0.25V</u> |
| CR6045-221M | <u>220</u>  | <u>20</u> | <u>890</u>  | <u>0.63</u> | <u>0.55</u> | <u>100KHz /0.25V</u> |
| CR8040-R56N | <u>0.56</u> | <u>30</u> | <u>5</u>    | <u>11.5</u> | <u>7.6</u>  | <u>1MHz /0.25V</u>   |
| CR8040-1R0N | <u>1</u>    | <u>30</u> | <u>8</u>    | <u>9.85</u> | <u>6.3</u>  | <u>100KHz /0.25V</u> |
| CR8040-1R5N | <u>1.5</u>  | <u>30</u> | <u>10</u>   | <u>8.15</u> | <u>5.65</u> | <u>100KHz /0.25V</u> |
| CR8040-2R2N | <u>2.2</u>  | <u>30</u> | <u>12</u>   | <u>7.1</u>  | <u>5.15</u> | <u>100KHz /0.25V</u> |
| CR8040-3R3N | <u>3.3</u>  | <u>30</u> | <u>17</u>   | <u>6.5</u>  | <u>4.4</u>  | <u>100KHz /0.25V</u> |
| CR8040-4R7N | <u>4.7</u>  | <u>30</u> | <u>20</u>   | <u>5.9</u>  | <u>4</u>    | <u>100KHz /0.25V</u> |
| CR8040-5R6N | <u>5.6</u>  | <u>30</u> | <u>24</u>   | <u>5.5</u>  | <u>3.8</u>  | <u>100KHz /0.25V</u> |
| CR8040-6R8M | <u>6.8</u>  | <u>20</u> | <u>28</u>   | <u>4.55</u> | <u>3.6</u>  | <u>100KHz /0.25V</u> |
| CR8040-8R2M | <u>8.2</u>  | <u>20</u> | <u>35</u>   | <u>4.2</u>  | <u>3.4</u>  | <u>100KHz /0.25V</u> |
| CR8040-100M | <u>10</u>   | <u>20</u> | <u>37</u>   | <u>3.6</u>  | <u>3.1</u>  | <u>100KHz /0.25V</u> |
| CR8040-120M | <u>12</u>   | <u>20</u> | <u>45</u>   | <u>3.3</u>  | <u>2.8</u>  | <u>100KHz /0.25V</u> |
| CR8040-150M | <u>15</u>   | <u>20</u> | <u>56</u>   | <u>2.95</u> | <u>2.5</u>  | <u>100KHz /0.25V</u> |
| CR8040-180M | <u>18</u>   | <u>20</u> | <u>58</u>   | <u>2.7</u>  | <u>2.4</u>  | <u>100KHz /0.25V</u> |
| CR8040-220M | <u>22</u>   | <u>20</u> | <u>74</u>   | <u>2.4</u>  | <u>2</u>    | <u>100KHz /0.25V</u> |
| CR8040-270M | <u>27</u>   | <u>20</u> | <u>80</u>   | <u>2.15</u> | <u>1.9</u>  | <u>100KHz /0.25V</u> |
| CR8040-330M | <u>33</u>   | <u>20</u> | <u>100</u>  | <u>2.05</u> | <u>1.7</u>  | <u>100KHz /0.25V</u> |
| CR8040-470M | <u>47</u>   | <u>20</u> | <u>158</u>  | <u>1.75</u> | <u>1.5</u>  | <u>100KHz /0.25V</u> |
| CR8040-560M | <u>56</u>   | <u>20</u> | <u>160</u>  | <u>1.55</u> | <u>1.4</u>  | <u>100KHz /0.25V</u> |
| CR8040-680M | <u>68</u>   | <u>20</u> | <u>196</u>  | <u>1.45</u> | <u>1.2</u>  | <u>100KHz /0.25V</u> |
| CR8040-820M | <u>82</u>   | <u>20</u> | <u>245</u>  | <u>1.3</u>  | <u>1.1</u>  | <u>100KHz /0.25V</u> |
| CR8040-101M | <u>100</u>  | <u>20</u> | <u>295</u>  | <u>1.15</u> | <u>1</u>    | <u>100KHz /0.25V</u> |
| CR8040-151M | <u>150</u>  | <u>20</u> | <u>470</u>  | <u>1.1</u>  | <u>0.8</u>  | <u>100KHz /0.25V</u> |
| CR8040-171M | <u>170</u>  | <u>20</u> | <u>538</u>  | <u>0.95</u> | <u>0.75</u> | <u>100KHz /0.25V</u> |
| CR8040-181M | <u>180</u>  | <u>20</u> | <u>610</u>  | <u>0.9</u>  | <u>0.75</u> | <u>100KHz /0.25V</u> |
| CR8040-221M | <u>220</u>  | <u>20</u> | <u>660</u>  | <u>0.85</u> | <u>0.7</u>  | <u>100KHz /0.25V</u> |
| CR8040-331M | <u>330</u>  | <u>20</u> | <u>970</u>  | <u>0.68</u> | <u>0.55</u> | <u>100KHz /0.25V</u> |
| CR8040-471M | <u>470</u>  | <u>20</u> | <u>1400</u> | <u>0.6</u>  | <u>0.48</u> | <u>100KHz /0.25V</u> |
| CR8040-681M | <u>680</u>  | <u>20</u> | <u>1750</u> | <u>0.5</u>  | <u>0.45</u> | <u>100KHz /0.25V</u> |

## CKRH 系列

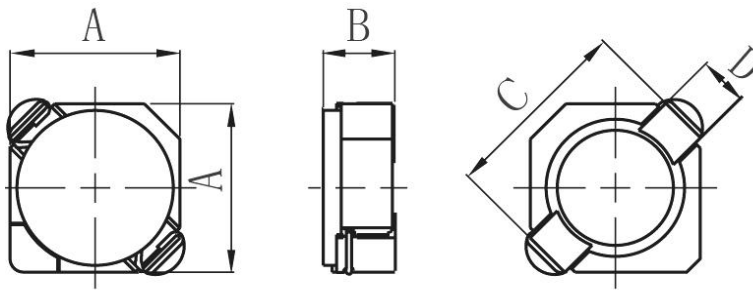

| 型号       | A            | B            | C           | D            |
|----------|--------------|--------------|-------------|--------------|
| CKRH2B11 | 3.20mm (Max) | 1.28mm (Max) | 3.3mm (REF) | 1.1mm (REF)  |
| CKRH2B14 | 3.20mm (Max) | 1.5mm (Max)  | 3.3mm (REF) | 1.1mm (REF)  |
| CKRH2B18 | 3.20mm (Max) | 2.0mm (Max)  | 3.3mm (REF) | 1.1mm (REF)  |
| CKRH3B12 | 4.0mm (Max)  | 1.4mm (Max)  | 5.5mm (REF) | 1.5mm (REF)  |
| CKRH3B16 | 4.0mm (Max)  | 1.8mm (Max)  | 5.5mm (REF) | 1.5mm (REF)  |
| CKRH4B18 | 5.0mm (Max)  | 2.0mm (Max)  | 6.9mm (REF) | 1.9mm (REF)  |
| CKRH4B28 | 5.0mm (Max)  | 3.0mm (Max)  | 6.9mm (REF) | 1.9mm (REF)  |
| CKRH5B18 | 6.1mm (Max)  | 2.0mm (Max)  | 8.2mm (REF) | 2.15mm (REF) |
| CKRH5B28 | 6.1mm (Max)  | 3.0mm (Max)  | 8.2mm (REF) | 2.15mm (REF) |
| CKRH6B28 | 7.2mm (Max)  | 3.1mm (Max)  | 9.5mm (REF) | 2.65mm (REF) |
| CKRH6B38 | 7.2mm (Max)  | 4.1mm (Max)  | 9.5mm (REF) | 2.65mm (REF) |
| CKRH8B28 | 8.3mm (Max)  | 3.1mm (Max)  | 9.5mm (REF) | 2.8mm (REF)  |
| CKRH8B38 | 8.3mm (Max)  | 4.1mm (Max)  | 9.5mm (REF) | 2.8mm (REF)  |
| CKRH8B48 | 8.3mm (Max)  | 5.1mm (Max)  | 9.5mm (REF) | 2.8mm (REF)  |

2) 包装 (编带装) 尺寸:

13" 盘

| PART No.      | NOMINAL<br>INDUCTANCE (uH) | DCR<br>(Ω)MAX | IDC<br>(A)MAX |
|---------------|----------------------------|---------------|---------------|
| CKRH2B11-2R2N | 2.2                        | 106.60m       | 800m          |
| CKRH2B11-2R7N | 2.7                        | 109.00m       | 720m          |
| CKRH2B11-3R3N | 3.3                        | 137.00m       | 600m          |
| CKRH2B11-4R7N | 4.7                        | 166.00m       | 515m          |
| CKRH2B11-6R8N | 6.8                        | 256.00m       | 420m          |
| CKRH2B11-100M | 10                         | 340.00m       | 350m          |
| CKRH2B11-150M | 15                         | 572.00m       | 270m          |
| CKRH2B11-220M | 22                         | 845.00m       | 250m          |
| CKRH2B11-330M | 33                         | 1.30          | 180m          |
| CKRH2B11-470M | 47                         | 1.70          | 130m          |
| CKRH2B11-560M | 56                         | 1.95          | 120m          |
| CKRH2B11-680M | 68                         | 2.40          | 115m          |
| CKRH2B11-820M | 82                         | 3.10          | 110m          |
| CKRH2B11-101M | 100                        | 3.28          | 100m          |

※ 测试条件：L≤8.2uH 测试频率 100KHz / 0.25V, (N±30%);

L>8.2uH 测试频率 1KHz / 0.25V, (M±20%);

※ 测试仪表：HP4291B、502BC、CH1062。

| PART No.      | NOMINAL<br>INDUCTANCE (uH) | DCR<br>( $\Omega$ )MAX | IDC<br>(A)MAX |
|---------------|----------------------------|------------------------|---------------|
| CKRH2B14-2R2N | 2.2                        | 95m                    | 900m          |
| CKRH2B14-2R7N | 2.7                        | 117m                   | 870m          |
| CKRH2B14-3R3N | 3.3                        | 121m                   | 850m          |
| CKRH2B14-4R7N | 4.7                        | 192m                   | 800m          |
| CKRH2B14-6R8N | 6.8                        | 234m                   | 800m          |
| CKRH2B14-100M | 10                         | 416m                   | 500m          |
| CKRH2B14-220M | 22                         | 936m                   | 400m          |
| CKRH2B14-330M | 33                         | 1.4                    | 300m          |
| CKRH2B18-2R2N | 2.2                        | 69.00m                 | 1.65          |
| CKRH2B18-3R3N | 3.3                        | 100.00m                | 1.45          |
| CKRH2B18-4R7N | 4.7                        | 180.00m                | 1.20          |
| CKRH2B18-6R2N | 6.2                        | 221.00m                | 850m          |
| CKRH2B18-6R3N | 6.3                        | 221.00m                | 850m          |
| CKRH2B18-6R8N | 6.8                        | 221.00m                | 850m          |
| CKRH2B18-100M | 10                         | 348.00m                | 770m          |
| CKRH2B18-220M | 22                         | 735.00m                | 540m          |
| CKRH2B18-330M | 33                         | 1.3                    | 400m          |
| CKRH2B18-470M | 47                         | 1.8                    | 370m          |
|               |                            |                        |               |
|               |                            |                        |               |
|               |                            |                        |               |
|               |                            |                        |               |
|               |                            |                        |               |

※ 测试条件：L $\leq$ 8.2uH 测试频率 100KHz / 0.25V, (N $\pm$ 30%);

L $>$ 8.2uH 测试频率 1KHz / 0.25V, (M $\pm$ 20%);

※ 测试仪表：502BC、CH1062。

| PART No.      | NOMINAL<br>INDUCTANCE (uH) | DCR<br>(Ω)MAX | IDC<br>(A) |
|---------------|----------------------------|---------------|------------|
| CKRH3B12-1R0N | 1.0                        | 87.00m        | 1.20       |
| CKRH3B12-1R5N | 1.5                        | 124.00m       | 1.10       |
| CKRH3B12-1R8N | 1.8                        | 142.00m       | 1.04       |
| CKRH3B12-3R3N | 3.3                        | 239.00m       | 800m       |
| CKRH3B12-4R7N | 4.7                        | 338.00m       | 730m       |
| CKRH3B12-6R8N | 6.8                        | 406.00m       | 640m       |
| CKRH3B12-100M | 10                         | 622.00m       | 495m       |
| CKRH3B12-150M | 15                         | 977.00m       | 425m       |
| CKRH3B12-220M | 22                         | 1.16          | 380m       |
| CKRH3B12-330M | 33                         | 1.90          | 315m       |
| CKRH3B12-470M | 47                         | 2.30          | 260m       |

※ 测试条件：L≤8.2uH 测试频率 100KHz / 0.25V, (N±30%);

L>8.2uH 测试频率 1KHz / 0.25V, (M±20%);

※ 测试仪表：HP4291B、502BC。

| PART No.       | NOMINAL<br>INDUCTANCE (uH) | DCR<br>(Ω)MAX | IDC<br>(A)MAX |
|----------------|----------------------------|---------------|---------------|
| CKRH3B16B-1R0N | 1.0                        | 45.50m        | 1.47          |
| CKRH3B16B-1R5N | 1.5                        | 52.00m        | 1.45          |
| CKRH3B16B-2R2N | 2.2                        | 72.00m        | 1.20          |
| CKRH3B16B-2R7N | 2.7                        | 75.00m        | 1.18          |
| CKRH3B16B-3R3N | 3.3                        | 85.00m        | 1.10          |
| CKRH3B16B-3R9N | 3.9                        | 95.00m        | 1.00          |
| CKRH3B16B-4R7N | 4.7                        | 105.00m       | 900m          |
| CKRH3B16B-5R6N | 5.6                        | 119.60m       | 822m          |
| CKRH3B16B-6R8N | 6.8                        | 170.00m       | 730m          |
| CKRH3B16B-8R2N | 8.2                        | 190.00m       | 621m          |
| CKRH3B16B-100M | 10                         | 210m          | 550m          |
| CKRH3B16B-120M | 12                         | 247m          | 500m          |
| CKRH3B16B-150M | 15                         | 295m          | 450m          |
| CKRH3B16B-180M | 18                         | 416m          | 410m          |
| CKRH3B16B-220M | 22                         | 430m          | 400m          |
| CKRH3B16B-270M | 27                         | 546m          | 370m          |
| CKRH3B16B-330M | 33                         | 675m          | 320m          |
| CKRH3B16B-390M | 39                         | 871m          | 278m          |
| CKRH3B16B-470M | 47                         | 962m          | 260m          |
| CKRH3B16B-560M | 56                         | 1.09          | 242m          |
| CKRH3B16B-680M | 68                         | 1.25          | 219m          |
| CKRH3B16B-820M | 82                         | 1.50          | 200m          |
| CKRH3B16B-101M | 100                        | 1.68          | 187m          |
| CKRH3B16B-121M | 120                        | 2.15          | 178m          |
| CKRH3B16B-151M | 150                        | 2.60          | 150m          |
| CKRH3B16B-181M | 180                        | 2.86          | 138m          |
| CKRH3B16B-221M | 220                        | 4.55          | 122m          |
| CKRH3B16B-271M | 270                        | 5.07          | 105m          |
| CKRH3B16B-331M | 330                        | 5.89          | 98m           |
| CKRH3B16B-391M | 390                        | 6.50          | 96m           |
| CKRH3B16B-471M | 470                        | 7.15          | 81m           |
| CKRH3B16B-561M | 560                        | 9.75          | 70m           |
| CKRH3B16B-681M | 680                        | 12.74         | 69m           |

※ 测试条件:  $L \leq 8.2\mu\text{H}$  测试频率 100KHz / 0.25V, (N±30%);

$L > 8.2\mu\text{H}$  测试频率 1KHz / 0.25V, (M±20%);

※ 测试仪表: HP4291B、502BC。

| PART No.      | NOMINAL<br>INDUCTANCE (uH) | DCR<br>(Ω)MAX | IDC<br>(A)MAX |
|---------------|----------------------------|---------------|---------------|
| CKRH4B18-1R0N | 1.0                        | 28.60m        | 1.80          |
| CKRH4B18-1R5N | 1.5                        | 45.50m        | 1.45          |
| CKRH4B18-2R2N | 2.2                        | 52.00m        | 1.40          |
| CKRH4B18-2R7N | 2.7                        | 58.50m        | 1.30          |
| CKRH4B18-3R3N | 3.3                        | 62.40m        | 1.15          |
| CKRH4B18-3R9N | 3.9                        | 65.00m        | 900m          |
| CKRH4B18-4R7N | 4.7                        | 78.00m        | 860m          |
| CKRH4B18-5R6N | 5.6                        | 98.80m        | 820m          |
| CKRH4B18-6R8N | 6.8                        | 143.00m       | 780m          |
| CKRH4B18-8R2N | 8.2                        | 156.00m       | 700m          |
| CKRH4B18-100M | 10                         | 158.60m       | 620m          |
| CKRH4B18-150M | 15                         | 247m          | 500m          |
| CKRH4B18-220M | 22                         | 260m          | 420m          |
| CKRH4B18-330M | 33                         | 546m          | 335m          |
| CKRH4B18-390M | 39                         | 585m          | 315m          |
| CKRH4B18-470M | 47                         | 845m          | 295m          |
| CKRH4B18-560M | 56                         | 910m          | 275m          |
| CKRH4B18-680M | 68                         | 1.00          | 245m          |
| CKRH4B18-820M | 82                         | 1.30          | 225m          |
| CKRH4B18-101M | 100                        | 1.56          | 205m          |
| CKRH4B18-121M | 120                        | 2.10          | 185m          |
| CKRH4B18-151M | 150                        | 2.34          | 155m          |
| CKRH4B18-181M | 180                        | 2.60          | 145m          |
| CKRH4B18-221M | 220                        | 3.38          | 140m          |
| CKRH4B18-271M | 270                        | 4.03          | 135m          |
| CKRH4B18-331M | 330                        | 4.56          | 130m          |
| CKRH4B18-391M | 390                        | 5.07          | 125m          |
| CKRH4B18-471M | 470                        | 5.46          | 120m          |
| CKRH4B18-561M | 560                        | 8.19          | 112m          |
| CKRH4B18-681M | 680                        | 10.01         | 108m          |

※ 测试条件：L≤8.2uH 测试频率 100KHz / 0.25V, (N±30%);

L>8.2uH 测试频率 1KHz / 0.25V, (M±20%);

※ 测试仪表：HP4291B、502BC、CH1062。

| PART No.      | NOMINAL<br>INDUCTANCE (uH) | DCR<br>(Ω)MAX | IDC<br>(A)MAX |
|---------------|----------------------------|---------------|---------------|
| CKRH4B28-1R0N | 1.0                        | 25.74m        | 2.70          |
| CKRH4B28-2R2N | 2.2                        | 33.80m        | 1.80          |
| CKRH4B28-3R0N | 3.0                        | 48.10m        | 1.55          |
| CKRH4B28-3R9N | 3.9                        | 48.10m        | 1.50          |
| CKRH4B28-4R7N | 4.7                        | 52.00m        | 1.35          |
| CKRH4B28-5R6N | 5.6                        | 58.50m        | 1.21          |
| CKRH4B28-6R8N | 6.8                        | 88.40m        | 1.15          |
| CKRH4B28-100M | 10                         | 119.60m       | 1.00          |
| CKRH4B28-120M | 12                         | 140.40m       | 840m          |
| CKRH4B28-150M | 15                         | 156.00m       | 752m          |
| CKRH4B28-180M | 18                         | 195.00m       | 730m          |
| CKRH4B28-220M | 22                         | 247.00m       | 700m          |
| CKRH4B28-270M | 27                         | 299.00m       | 585m          |
| CKRH4B28-330M | 33                         | 325.00m       | 570m          |
| CKRH4B28-390M | 39                         | 351.00m       | 520m          |
| CKRH4B28-430M | 43                         | 377.00m       | 510m          |
| CKRH4B28-470M | 47                         | 442.00m       | 500m          |
| CKRH4B28-560M | 56                         | 468.00m       | 420m          |
| CKRH4B28-680M | 68                         | 546.00m       | 352m          |
| CKRH4B28-820M | 82                         | 780.00m       | 330m          |
| CKRH4B28-101M | 100                        | 858.00m       | 300m          |
| CKRH4B28-121M | 120                        | 1.30          | 280m          |
| CKRH4B28-151M | 150                        | 1.50          | 250m          |
| CKRH4B28-181M | 180                        | 1.60          | 230m          |
| CKRH4B28-221M | 220                        | 1.82          | 210m          |
| CKRH4B28-271M | 270                        | 2.86          | 185m          |
| CKRH4B28-331M | 330                        | 3.25          | 170m          |
| CKRH4B28-391M | 390                        | 4.55          | 155m          |
| CKRH4B28-471M | 470                        | 5.07          | 140m          |
| CKRH4B28-561M | 560                        | 5.46          | 130m          |
| CKRH4B28-681M | 680                        | 6.11          | 120m          |

※ 测试条件：L≤8.2uH 测试频率 100KHz / 0.25V, (N±30%)；

L>8.2uH 测试频率 1KHz / 0.25V, (M±20%)；

※ 测试仪表：HIOKI3532、HIOKI 3540、MICROTEST6337、MICROTEST6220、DR130。

| PART No.      | NOMINAL<br>INDUCTANCE (uH) | DCR<br>(Ω)MAX | IDC<br>(A)MAX |
|---------------|----------------------------|---------------|---------------|
| CKRH5B18-1R0N | 1.0                        | 17.68m        | 3.00          |
| CKRH5B18-1R5N | 1.5                        | 33.00m        | 2.30          |
| CKRH5B18-2R2N | 2.2                        | 36.40m        | 2.10          |
| CKRH5B18-2R7N | 2.7                        | 40.30m        | 2.00          |
| CKRH5B18-3R3N | 3.3                        | 49.40m        | 1.83          |
| CKRH5B18-4R7N | 4.7                        | 65.00m        | 1.60          |
| CKRH5B18-5R6N | 5.6                        | 72.80m        | 1.45          |
| CKRH5B18-6R8N | 6.8                        | 78.00m        | 1.31          |
| CKRH5B18-8R2N | 8.2                        | 96.20m        | 1.10          |
| CKRH5B18-100M | 10                         | 124.00m       | 1.04          |
| CKRH5B18-120M | 12                         | 153.00m       | 950m          |
| CKRH5B18-150M | 15                         | 196.00m       | 850m          |
| CKRH5B18-180M | 18                         | 210.00m       | 790m          |
| CKRH5B18-220M | 22                         | 290.00m       | 700m          |
| CKRH5B18-270M | 27                         | 330.00m       | 655m          |
| CKRH5B18-330M | 33                         | 385.00m       | 585m          |
| CKRH5B18-390M | 39                         | 520.00m       | 510m          |
| CKRH5B18-470M | 47                         | 595.00m       | 480m          |
| CKRH5B18-560M | 56                         | 665.00m       | 430m          |
| CKRH5B18-680M | 68                         | 840.00m       | 400m          |
| CKRH5B18-820M | 82                         | 978.00m       | 360m          |
| CKRH5B18-101M | 100                        | 1.20          | 325m          |
| CKRH5B18-121M | 120                        | 1.30          | 295m          |
| CKRH5B18-151M | 150                        | 1.61          | 270m          |
| CKRH5B18-181M | 180                        | 2.05          | 245m          |
| CKRH5B18-221M | 220                        | 2.29          | 225m          |
| CKRH5B18-271M | 270                        | 2.99          | 200m          |
| CKRH5B18-331M | 330                        | 3.51          | 185m          |
| CKRH5B18-391M | 390                        | 4.16          | 155m          |
| CKRH5B18-471M | 470                        | 4.81          | 150m          |
| CKRH5B18-561M | 560                        | 5.20          | 140m          |
| CKRH5B18-681M | 680                        | 6.37          | 130m          |

※ 测试条件:  $L \leq 8.2\mu\text{H}$  测试频率 100KHz / 0.25V, (N $\pm$ 30%);

$L > 8.2\mu\text{H}$  测试频率 1KHz / 0.25V, (M $\pm$ 20%);

※ 测试仪表: HP4291B、502BC、CH1062。

| PART No.      | NOMINAL<br>INDUCTANCE (uH) | DCR<br>(Ω)MAX | IDC<br>(A)MAX |
|---------------|----------------------------|---------------|---------------|
| CKRH5B28-1R0N | 1.0                        | 15.60m        | 3.45          |
| CKRH5B28-1R8N | 1.8                        | 22.10m        | 2.70          |
| CKRH5B28-2R2N | 2.2                        | 24.70m        | 2.30          |
| CKRH5B28-2R7N | 2.7                        | 28.60m        | 2.26          |
| CKRH5B28-3R3N | 3.3                        | 32.50m        | 2.23          |
| CKRH5B28-4R7N | 4.7                        | 39.00m        | 1.90          |
| CKRH5B28-5R6N | 5.6                        | 44.20m        | 1.76          |
| CKRH5B28-6R8N | 6.8                        | 52.00m        | 1.63          |
| CKRH5B28-8R2N | 8.2                        | 58.50m        | 1.50          |
| CKRH5B28-100M | 10                         | 78.00m        | 1.30          |
| CKRH5B28-120M | 12                         | 84.50m        | 1.20          |
| CKRH5B28-150M | 15                         | 114.4m        | 1.10          |
| CKRH5B28-180M | 18                         | 119.6m        | 1.00          |
| CKRH5B28-220M | 22                         | 156.00m       | 890m          |
| CKRH5B28-270M | 27                         | 188.50m       | 800m          |
| CKRH5B28-330M | 33                         | 206.70m       | 730m          |
| CKRH5B28-390M | 39                         | 230.75m       | 690m          |
| CKRH5B28-470M | 47                         | 260m          | 610m          |
| CKRH5B28-560M | 56                         | 338m          | 560m          |
| CKRH5B28-680M | 68                         | 364m          | 505m          |
| CKRH5B28-820M | 82                         | 416m          | 460m          |
| CKRH5B28-101M | 100                        | 572m          | 415m          |
| CKRH5B28-121M | 120                        | 676m          | 390m          |
| CKRH5B28-151M | 150                        | 790m          | 300m          |
| CKRH5B28-181M | 180                        | 996m          | 290m          |
| CKRH5B28-221M | 220                        | 1.30          | 285m          |
| CKRH5B28-271M | 270                        | 1.52          | 255m          |
| CKRH5B28-331M | 330                        | 2.21          | 230m          |
| CKRH5B28-391M | 390                        | 2.40          | 210m          |
| CKRH5B28-471M | 470                        | 2.60          | 190m          |
| CKRH5B28-561M | 560                        | 2.96          | 175m          |
| CKRH5B28-681M | 680                        | 3.77          | 165m          |

※ 测试条件:  $L \leq 8.2\mu\text{H}$  测试频率 100KHz / 0.25V, (N $\pm$ 30%);

$L > 8.2\mu\text{H}$  测试频率 1KHz / 0.25V, (M $\pm$ 20%);

※ 测试仪表: HP4291B、502BC、CH1062。

| PART No.      | NOMINAL<br>INDUCTANCE (uH) | DCR<br>(Ω)MAX | IDC<br>(A)MAX |
|---------------|----------------------------|---------------|---------------|
| CKRH6B28-1R0N | 1.0                        | 18.2m         | 3.60          |
| CKRH6B28-1R8N | 1.8                        | 20.8m         | 3.45          |
| CKRH6B28-2R2N | 2.2                        | 24.7m         | 3.15          |
| CKRH6B28-2R7N | 2.7                        | 27.3m         | 2.84          |
| CKRH6B28-3R3N | 3.3                        | 29.9m         | 2.80          |
| CKRH6B28-3R9N | 3.9                        | 32.5m         | 2.60          |
| CKRH6B28-4R7N | 4.7                        | 40.3m         | 2.30          |
| CKRH6B28-5R6N | 5.6                        | 45.5m         | 2.13          |
| CKRH6B28-6R8N | 6.8                        | 46.8m         | 1.88          |
| CKRH6B28-8R2N | 8.2                        | 55.9m         | 1.73          |
| CKRH6B28-100M | 10                         | 75.4m         | 1.60          |
| CKRH6B28-120M | 12                         | 80.6m         | 1.50          |
| CKRH6B28-150M | 15                         | 89.7m         | 1.34          |
| CKRH6B28-180M | 18                         | 93.6m         | 1.21          |
| CKRH6B28-220M | 22                         | 122.2m        | 1.10          |
| CKRH6B28-270M | 27                         | 131.3m        | 1.02          |
| CKRH6B28-330M | 33                         | 159.9m        | 918m          |
| CKRH6B28-390M | 39                         | 195m          | 835m          |
| CKRH6B28-470M | 47                         | 234m          | 745m          |
| CKRH6B28-560M | 56                         | 273m          | 685m          |
| CKRH6B28-680M | 68                         | 364m          | 607m          |
| CKRH6B28-820M | 82                         | 403m          | 570m          |
| CKRH6B28-101M | 100                        | 507m          | 520m          |
| CKRH6B28-121M | 120                        | 676m          | 450m          |
| CKRH6B28-151M | 150                        | 806m          | 410m          |
| CKRH6B28-181M | 180                        | 949m          | 380m          |
| CKRH6B28-221M | 220                        | 1.11          | 350m          |
| CKRH6B28-271M | 270                        | 1.56          | 310m          |
| CKRH6B28-331M | 330                        | 1.70          | 285m          |
| CKRH6B28-391M | 390                        | 1.95          | 253m          |
| CKRH6B28-471M | 470                        | 2.73          | 230m          |
| CKRH6B28-561M | 560                        | 2.99          | 220m          |
| CKRH6B28-681M | 680                        | 3.51          | 193m          |

※ 测试条件：L≤8.2uH 测试频率 100KHz / 0.25V, (N±30%)；

L>8.2uH 测试频率 1KHz / 0.25V, (M±20%)；

※ 测试仪表：HP4291B、502BC、CH1062。

| PART No.      | NOMINAL<br>INDUCTANCE (uH) | DCR<br>(Ω)MAX | IDC<br>(A)MAX |
|---------------|----------------------------|---------------|---------------|
| CKRH6B38-1R0N | 1.0                        | 19.5m         | 5.00          |
| CKRH6B38-1R8N | 1.8                        | 23.4m         | 3.90          |
| CKRH6B38-2R7N | 2.7                        | 28.6m         | 3.40          |
| CKRH6B38-3R3N | 3.3                        | 33.8m         | 2.95          |
| CKRH6B38-3R9N | 3.9                        | 36.4m         | 2.90          |
| CKRH6B38-4R7N | 4.7                        | 37.7m         | 2.88          |
| CKRH6B38-5R6N | 5.6                        | 41.6m         | 2.61          |
| CKRH6B38-6R8N | 6.8                        | 49.4m         | 2.39          |
| CKRH6B38-8R2N | 8.2                        | 54.6m         | 2.07          |
| CKRH6B38-100M | 10                         | 63.7m         | 2.00          |
| CKRH6B38-120M | 12                         | 78.0m         | 1.94          |
| CKRH6B38-150M | 15                         | 87.1m         | 1.60          |
| CKRH6B38-180M | 18                         | 106.6m        | 1.44          |
| CKRH6B38-220M | 22                         | 113.1m        | 1.30          |
| CKRH6B38-270M | 27                         | 130.0m        | 1.20          |
| CKRH6B38-330M | 33                         | 143.0m        | 1.07          |
| CKRH6B38-390M | 39                         | 163.8m        | 1.00          |
| CKRH6B38-470M | 47                         | 182m          | 950m          |
| CKRH6B38-560M | 56                         | 221m          | 850m          |
| CKRH6B38-680M | 68                         | 247m          | 750m          |
| CKRH6B38-750M | 75                         | 286m          | 720m          |
| CKRH6B38-820M | 82                         | 324m          | 700m          |
| CKRH6B38-101M | 100                        | 380m          | 630m          |
| CKRH6B38-121M | 120                        | 442m          | 605m          |
| CKRH6B38-151M | 150                        | 572m          | 513m          |
| CKRH6B38-181M | 180                        | 637m          | 486m          |
| CKRH6B38-221M | 220                        | 936m          | 427m          |
| CKRH6B38-271M | 270                        | 1.00          | 387m          |
| CKRH6B38-331M | 330                        | 1.20          | 350m          |
| CKRH6B38-391M | 390                        | 1.30          | 318m          |
| CKRH6B38-471M | 470                        | 1.95          | 294m          |
| CKRH6B38-561M | 560                        | 2.34          | 260m          |
| CKRH6B38-681M | 680                        | 2.47          | 230m          |
| CKRH6B38-821M | 820                        | 3.50          | 170m          |

※ 测试条件:  $L \leq 8.2\mu\text{H}$  测试频率 100KHz / 0.25V, (N±30%);

$L > 8.2\mu\text{H}$  测试频率 1KHz / 0.25V, (M±20%);

※ 测试仪表: HP4291B、502BC、CH1062。

| PART No.       | NOMINAL<br>INDUCTANCE (uH) | DCR<br>(Ω)MAX | IDC<br>(A) |
|----------------|----------------------------|---------------|------------|
| CKRH8B28B-2R5N | 2.5                        | 26.00m        | 4.13       |
| CKRH8B28B-3R3N | 3.3                        | 32.50m        | 3.70       |
| CKRH8B28B-4R7N | 4.7                        | 58.50m        | 3.00       |
| CKRH8B28B-6R8N | 6.8                        | 62.00m        | 2.60       |
| CKRH8B28B-8R2N | 8.2                        | 85.00m        | 2.50       |
| CKRH8B28B-100M | 10                         | 91.00m        | 2.50       |
| CKRH8B28B-150M | 15                         | 137.00m       | 1.61       |
| CKRH8B28B-220M | 22                         | 195.00m       | 1.40       |
| CKRH8B28B-330M | 33                         | 319.00m       | 1.16       |
| CKRH8B28B-470M | 47                         | 423.00m       | 900m       |
| CKRH8B28B-680M | 68                         | 559.00m       | 750m       |
| CKRH8B28B-101M | 100                        | 793.00m       | 580m       |
| CKRH8B28B-121M | 120                        | 935.00m       | 510m       |
| CKRH8B28B-151M | 150                        | 1.09          | 470m       |
| CKRH8B28B-181M | 180                        | 1.65          | 420m       |
| CKRH8B28B-221M | 220                        | 1.82          | 400m       |
| CKRH8B28B-331M | 330                        | 2.00          | 330m       |

※ 测试条件：L≤8.2uH 测试频率 100KHz / 0.25V, (N±30%);

L>8.2uH 测试频率 1KHz / 0.25V, (M±20%);

※ 测试仪表：HP4291B、502BC。

| PART No.       | NOMINAL<br>INDUCTANCE (uH) | DCR<br>(Ω)MAX | IDC<br>(A) |
|----------------|----------------------------|---------------|------------|
| CKRH8B38B-2R2N | 2.2                        | 20m           | 5.40       |
| CKRH8B38B-3R9N | 3.9                        | 29m           | 4.30       |
| CKRH8B38B-5R6N | 5.6                        | 32.5m         | 3.50       |
| CKRH8B38B-6R8N | 6.8                        | 36m           | 3.00       |
| CKRH8B38B-100M | 10                         | 49m           | 2.70       |
| CKRH8B38B-150M | 15                         | 75m           | 2.30       |
| CKRH8B38B-220M | 22                         | 109m          | 1.88       |
| CKRH8B38B-330M | 33                         | 163m          | 1.52       |
| CKRH8B38B-470M | 47                         | 211m          | 1.28       |
| CKRH8B38B-680M | 68                         | 304m          | 1.10       |
| CKRH8B38B-101M | 100                        | 416m          | 880m       |
| CKRH8B38B-121M | 120                        | 494m          | 830m       |
| CKRH8B38B-151M | 150                        | 598m          | 780m       |
| CKRH8B38B-181M | 180                        | 780m          | 700m       |
| CKRH8B38B-221M | 220                        | 910m          | 636m       |
| CKRH8B38B-271M | 270                        | 1.1           | 550m       |

※ 测试条件：L≤8.2uH 测试频率 100KHz / 0.25V, (N±30%);

L>8.2uH 测试频率 1KHz / 0.25V, (M±20%);

※ 测试仪表：HP4291B、502BC。

| PART No.      | NOMINAL<br>INDUCTANCE (uH) | DCR<br>(Ω)MAX | IDC<br>(A) |
|---------------|----------------------------|---------------|------------|
| CKRH8B43-1R8N | 1.8                        | 16.00m        | 5.15       |
| CKRH8B43-2R5N | 2.5                        | 20.00m        | 5.00       |
| CKRH8B43-3R9N | 3.9                        | 22.00m        | 4.50       |
| CKRH8B43-4R7N | 4.7                        | 30.00m        | 4.00       |
| CKRH8B43-6R8N | 6.8                        | 33.00m        | 3.87       |
| CKRH8B43-100M | 10                         | 44.00m        | 3.10       |
| CKRH8B43-120M | 12                         | 69.00m        | 2.50       |
| CKRH8B43-150M | 15                         | 60.00m        | 2.35       |
| CKRH8B43-220M | 22                         | 82.00m        | 1.90       |
| CKRH8B43-330M | 33                         | 125.00m       | 1.62       |
| CKRH8B43-470M | 47                         | 176.00m       | 1.35       |
| CKRH8B43-680M | 68                         | 247.00m       | 1.20       |
| CKRH8B43-101M | 100                        | 377.00m       | 1.02       |
| CKRH8B43-121M | 120                        | 429.00m       | 900m       |
| CKRH8B43-151M | 150                        | 520.00m       | 830m       |
| CKRH8B43-181M | 180                        | 624.00m       | 785m       |
| CKRH8B43-221M | 220                        | 793.00m       | 685m       |
| CKRH8B43-271M | 270                        | 962.00m       | 620m       |
| CKRH8B43-331M | 330                        | 1.23          | 540m       |

※ 测试条件：L≤8.2uH 测试频率 100KHz / 0.25V, (N±30%);

L>8.2uH 测试频率 1KHz / 0.25V, (M±20%);

※ 测试仪表：HP4291B、502BC。

| PART No.    | NOMINAL<br>INDUCTANCE (uH) | DCR<br>(Ω)MAX | IDC<br>(A)MAX |
|-------------|----------------------------|---------------|---------------|
| CKRH73-1R0N | 1.0                        | 40.30m        | 4.00          |
| CKRH73-2R2N | 2.2                        | 55.30m        | 3.50          |
| CKRH73-4R7N | 4.7                        | 42.90m        | 2.70          |
| CKRH73-6R8N | 6.8                        | 52.00m        | 2.50          |
| CKRH73-100M | 10                         | 119.60m       | 1.70          |
| CKRH73-120M | 12                         | 136.50m       | 1.60          |
| CKRH73-150M | 15                         | 123.50m       | 1.40          |
| CKRH73-180M | 18                         | 193.70m       | 1.30          |
| CKRH73-220M | 22                         | 195.00m       | 1.20          |
| CKRH73-270M | 27                         | 227.50m       | 1.00          |
| CKRH73-330M | 33                         | 260.00m       | 970m          |
| CKRH73-390M | 39                         | 273.00m       | 940m          |
| CKRH73-470M | 47                         | 312.00m       | 900m          |
| CKRH73-560M | 56                         | 507.00m       | 800m          |
| CKRH73-680M | 68                         | 585.00m       | 720m          |
| CKRH73-820M | 82                         | 676.00m       | 600m          |
| CKRH73-101M | 100                        | 728.00m       | 540m          |
| CKRH73-121M | 120                        | 910.00m       | 510m          |
| CKRH73-151M | 150                        | 1.04          | 440m          |
| CKRH73-181M | 180                        | 1.24          | 380m          |
| CKRH73-221M | 220                        | 1.69          | 350m          |
| CKRH73-271M | 270                        | 1.95          | 340m          |
| CKRH73-331M | 330                        | 2.08          | 305m          |
| CKRH73-391M | 390                        | 3.12          | 280m          |
| CKRH73-471M | 470                        | 3.64          | 260m          |
| CKRH73-561M | 560                        | 4.16          | 250m          |
| CKRH73-102M | 1000                       | 7.80          | 160m          |

※ 测试条件：L≤8.2uH 测试频率 100KHz / 0.25V, (N±30%)；

L>8.2uH 测试频率 1KHz / 0.25V, (M±20%)；

※ 测试仪表：HP4291B、502BC。

| PART No.    | NOMINAL<br>INDUCTANCE (uH) | DCR<br>(Ω)MAX | IDC<br>(A)MAX |
|-------------|----------------------------|---------------|---------------|
| CKRH74-1R0N | 1.0                        | 20.0m         | 5.00          |
| CKRH74-1R5N | 1.5                        | 20.8m         | 4.60          |
| CKRH74-2R2N | 2.2                        | 24.7m         | 4.40          |
| CKRH74-3R9N | 3.9                        | 32.5m         | 3.30          |
| CKRH74-4R7N | 4.7                        | 39m           | 3.05          |
| CKRH74-6R8N | 6.8                        | 45.5m         | 2.90          |
| CKRH74-100M | 10                         | 65m           | 2.00          |
| CKRH74-120M | 12                         | 70.2m         | 1.90          |
| CKRH74-150M | 15                         | 78m           | 1.70          |
| CKRH74-180M | 18                         | 110.5m        | 1.55          |
| CKRH74-220M | 22                         | 126.1m        | 1.40          |
| CKRH74-270M | 27                         | 140.4m        | 1.30          |
| CKRH74-330M | 33                         | 176.8m        | 1.10          |
| CKRH74-390M | 39                         | 226.2m        | 1.03          |
| CKRH74-470M | 47                         | 260m          | 900m          |
| CKRH74-560M | 56                         | 286m          | 820m          |
| CKRH74-680M | 68                         | 338m          | 774m          |
| CKRH74-820M | 82                         | 364m          | 700m          |
| CKRH74-101M | 100                        | 403m          | 680m          |
| CKRH74-121M | 120                        | 546m          | 650m          |
| CKRH74-151M | 150                        | 689m          | 590m          |
| CKRH74-181M | 180                        | 767m          | 570m          |
| CKRH74-221M | 220                        | 1.24          | 470m          |
| CKRH74-271M | 270                        | 1.30          | 450m          |
| CKRH74-331M | 330                        | 1.52          | 425m          |
| CKRH74-391M | 390                        | 1.77          | 375m          |
| CKRH74-471M | 470                        | 2.60          | 330m          |
| CKRH74-561M | 560                        | 2.80          | 290m          |
| CKRH74-821M | 820                        | 3.25          | 240m          |

※ 测试条件：L≤8.2uH 测试频率 100KHz / 0.25V, (N±30%)；

L>8.2uH 测试频率 1KHz / 0.25V, (M±20%)；

※ 测试仪表：HP4291B、502BC。

| PART No.     | NOMINAL<br>INDUCTANCE (uH) | DCR<br>(Ω)MAX | IDC<br>(A) |
|--------------|----------------------------|---------------|------------|
| CKRH124-1R0N | 1.0                        | 8.00m         | 7.80       |
| CKRH124-1R5N | 1.5                        | 11.00m        | 7.20       |
| CKRH124-2R2N | 2.2                        | 13.00m        | 6.00       |
| CKRH124-3R3N | 3.3                        | 18.00m        | 5.40       |
| CKRH124-3R9N | 3.9                        | 21.00m        | 5.10       |
| CKRH124-4R7N | 4.7                        | 22.00m        | 4.80       |
| CKRH124-5R6N | 5.6                        | 23.00m        | 4.30       |
| CKRH124-6R8N | 6.8                        | 26.00m        | 4.20       |
| CKRH124-8R2N | 8.2                        | 31.00m        | 4.00       |
| CKRH124-100M | 10                         | 39.00m        | 3.90       |
| CKRH124-120M | 12                         | 44.00m        | 3.40       |
| CKRH124-150M | 15                         | 55.00m        | 3.20       |
| CKRH124-180M | 18                         | 65.00m        | 2.90       |
| CKRH124-220M | 22                         | 75.00m        | 2.50       |
| CKRH124-270M | 27                         | 86.00m        | 2.25       |
| CKRH124-330M | 33                         | 112.00m       | 2.00       |
| CKRH124-390M | 39                         | 121.00m       | 1.90       |
| CKRH124-470M | 47                         | 166.00m       | 1.80       |
| CKRH124-560M | 56                         | 182.00m       | 1.70       |
| CKRH124-680M | 68                         | 205.00m       | 1.55       |
| CKRH124-820M | 82                         | 243.00m       | 1.35       |
| CKRH124-101M | 100                        | 299.00m       | 1.20       |
| CKRH124-121M | 120                        | 358.00m       | 1.10       |
| CKRH124-151M | 150                        | 462.00m       | 950m       |
| CKRH124-181M | 180                        | 507.00m       | 850m       |
| CKRH124-221M | 220                        | 663.00m       | 800m       |
| CKRH124-271M | 270                        | 741.00m       | 650m       |
| CKRH124-331M | 330                        | 936.00m       | 550m       |
| CKRH124-391M | 390                        | 1.05          | 500m       |
| CKRH124-471M | 470                        | 1.30          | 440m       |
| CKRH124-561M | 560                        | 1.53          | 400m       |
| CKRH124-681M | 680                        | 1.72          | 370m       |
| CKRH124-821M | 820                        | 2.21          | 350m       |
| CKRH124-102M | 1000                       | 2.67          | 320m       |

※ 测试条件:  $L \leq 8.2\mu\text{H}$  测试频率 100KHz / 0.25V, (N $\pm$ 30%);

$L > 8.2\mu\text{H}$  测试频率 1KHz / 0.25V, (M $\pm$ 20%);

※ 测试仪表: HP4291B、502BC。

| PART No.     | NOMINAL<br>INDUCTANCE (uH) | DCR<br>(Ω)MAX | IDC<br>(A)MAX |
|--------------|----------------------------|---------------|---------------|
| CKRH125-1R0N | 1.0                        | 11.00m        | 8.50          |
| CKRH125-2R2N | 2.2                        | 15.50m        | 6.50          |
| CKRH125-2R7N | 2.7                        | 17.00m        | 6.00          |
| CKRH125-3R3N | 3.3                        | 18.00m        | 5.70          |
| CKRH125-4R7N | 4.7                        | 20.50m        | 4.70          |
| CKRH125-5R6N | 5.6                        | 21.00m        | 4.70          |
| CKRH125-6R8N | 6.8                        | 14.30m        | 4.40          |
| CKRH125-100M | 10                         | 25.00m        | 4.00          |
| CKRH125-120M | 12                         | 27.00m        | 3.50          |
| CKRH125-150M | 15                         | 30.00m        | 3.30          |
| CKRH125-180M | 18                         | 34.00m        | 3.00          |
| CKRH125-220M | 22                         | 36.00m        | 2.80          |
| CKRH125-270M | 27                         | 51.00m        | 2.30          |
| CKRH125-330M | 33                         | 57.00m        | 2.10          |
| CKRH125-390M | 39                         | 68.00m        | 2.00          |
| CKRH125-470M | 47                         | 75.00m        | 1.80          |
| CKRH125-560M | 56                         | 110.00m       | 1.70          |
| CKRH125-680M | 68                         | 120.00m       | 1.50          |
| CKRH125-820M | 82                         | 140.00m       | 1.40          |
| CKRH125-101M | 100                        | 160.00m       | 1.30          |
| CKRH125-121M | 120                        | 170.00m       | 1.10          |
| CKRH125-151M | 150                        | 230.00m       | 1.00          |
| CKRH125-181M | 180                        | 290.00m       | 900m          |
| CKRH125-221M | 220                        | 400.00m       | 800m          |
| CKRH125-271M | 270                        | 460.00m       | 750m          |
| CKRH125-331M | 330                        | 510.00m       | 680m          |
| CKRH125-391M | 390                        | 690.00m       | 650m          |
| CKRH125-471M | 470                        | 770.00m       | 580m          |
| CKRH125-561M | 560                        | 860.00m       | 540m          |

※ 测试条件:  $L \leq 8.2\mu\text{H}$  测试频率 100KHz / 0.25V, (N $\pm$ 30%);

$L > 8.2\mu\text{H}$  测试频率 1KHz / 0.25V, (M $\pm$ 20%);

※ 测试仪表: HP4291B、502BC、CH1062。

| PART No.     | NOMINAL<br>INDUCTANCE (uH) | DCR<br>(Ω)MAX | IDC<br>(A)MAX |
|--------------|----------------------------|---------------|---------------|
| CKRH127-1R0N | 1.0                        | 6.50m         | 10.40         |
| CKRH127-1R5N | 1.5                        | 8.50m         | 9.20          |
| CKRH127-2R2N | 2.2                        | 11.00m        | 8.40          |
| CKRH127-2R7N | 2.7                        | 12.20m        | 7.80          |
| CKRH127-3R3N | 3.3                        | 13.00m        | 7.60          |
| CKRH127-3R9N | 3.9                        | 14.00m        | 7.20          |
| CKRH127-4R7N | 4.7                        | 15.80m        | 6.80          |
| CKRH127-5R6N | 5.6                        | 16.70m        | 6.70          |
| CKRH127-6R8N | 6.8                        | 18.40m        | 6.50          |
| CKRH127-7R6N | 7.6                        | 20.00m        | 5.90          |
| CKRH127-100M | 10                         | 23.40m        | 5.40          |
| CKRH127-120M | 12                         | 26.00m        | 4.90          |
| CKRH127-150M | 15                         | 28.60m        | 4.50          |
| CKRH127-180M | 18                         | 39.20m        | 3.90          |
| CKRH127-220M | 22                         | 43.20m        | 3.60          |
| CKRH127-270M | 27                         | 51.09m        | 3.30          |
| CKRH127-330M | 33                         | 64.80m        | 3.00          |
| CKRH127-390M | 39                         | 72.90m        | 2.75          |
| CKRH127-470M | 47                         | 100.00m       | 2.50          |
| CKRH127-560M | 56                         | 110.00m       | 2.35          |
| CKRH127-680M | 68                         | 140.00m       | 2.10          |
| CKRH127-820M | 82                         | 160.00m       | 1.95          |
| CKRH127-101M | 100                        | 220.00m       | 1.70          |
| CKRH127-121M | 120                        | 250.00m       | 1.60          |
| CKRH127-151M | 150                        | 280.00m       | 1.42          |
| CKRH127-181M | 180                        | 290.00m       | 1.30          |
| CKRH127-221M | 220                        | 299.00m       | 1.16          |
| CKRH127-271M | 270                        | 403.00m       | 1.06          |
| CKRH127-331M | 330                        | 455.00m       | 950m          |
| CKRH127-391M | 390                        | 494.00m       | 880m          |
| CKRH127-471M | 470                        | 689.00m       | 790m          |
| CKRH127-561M | 560                        | 793.00m       | 730m          |
| CKRH127-681M | 680                        | 988.00m       | 650m          |
| CKRH127-821M | 820                        | 1.10          | 600m          |
| CKRH127-102M | 1000                       | 1.40          | 530m          |

※ 测试条件:  $L \leq 8.2\mu\text{H}$  测试频率 100KHz / 0.25V, (N $\pm$ 30%);

$L > 8.2\mu\text{H}$  测试频率 1KHz / 0.25V, (M $\pm$ 20%);

※ 测试仪表: HP4291B、502BC、CH1062。

# MOLDING POWER INDUCTOR.

## 一体成型系列

### Features

- Low profile and low DCR.
- Shielded construction.
- handles high transient current spikes without saturation
- frequency up to 3MHz
- Ultra Low buzz noise, due to composite construction
- 100% lead (Pb) free meet RoHS standard

### Applications

- PDA/Notebook/Desktop, and server applications.
- low profile,high current power supplies.
- Battery powered devices.
- DC/DC converters.



### Product Dimensions [unit: inch/ mm]

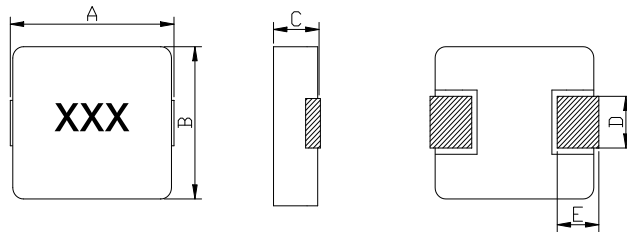

| Product Dimensions |            |           |          |          |          |
|--------------------|------------|-----------|----------|----------|----------|
| P/N                | ITEM       |           |          |          |          |
|                    | A          | B         | C        | D        | E        |
| <b>MPIF0420</b>    | 4.60±0.30  | 4.2±0.20  | 2.0 Max  | 1.50 Typ | 0.80 Typ |
| <b>MPIF0520</b>    | 5.50±0.40  | 5.20±0.20 | 2.0 Max  | 2.30 Typ | 1.20 Typ |
| <b>MPIF0530</b>    | 5.5±0.40   | 5.20±0.20 | 3.0 Max  | 2.30 Typ | 1.20 Typ |
| <b>MPIF0624</b>    | 7.10±0.30  | 6.60±0.20 | 2.40 Max | 3.0 Typ  | 1.60 Typ |
| <b>MPIF0630</b>    | 7.10±0.30  | 6.60±0.20 | 3.0 Max  | 3.0 Typ  | 1.60 Typ |
| <b>MPIF0650</b>    | 7.10±0.30  | 6.60±0.20 | 5.0 Max  | 3.0 Typ  | 1.60 Typ |
| <b>MPIF1040</b>    | 11.5 Max   | 10.0±0.30 | 4.0 Max  | 3.0 Typ  | 2.0 Typ  |
| <b>MPIF1050</b>    | 11.5 Max   | 10.0±0.30 | 5.0 Max  | 3.0 Typ  | 2.0 Typ  |
| <b>MPIF1350</b>    | 13.80±0.50 | 12.6±0.20 | 5.0 Max  | 3.7 Typ  | 2.5 Typ  |
| <b>MPIF1360</b>    | 13.80±0.50 | 12.6±0.20 | 6.0 Max  | 3.7 Typ  | 2.5 Typ  |

- All test data is referenced to 25°C ambient
- DC current (I<sub>rms</sub>) that will cause an approximate  $\Delta T$  of 40°C
- DC current (I<sub>sat</sub>) that will cause L<sub>o</sub> to drop approximately 30%
- Operating temperature Range: -55°C to +125°C
- Absolute maximum voltage 30VDC
- Operating temperature range -55°C ~ 125°C (Including self - temperature rise)

# MOLDING POWER INDUCTOR.

## 一体成型系列

**Electrical characteristics for MPIF0630 series**

| P/N           | 100KHz 1.0V         | D.C.R (mΩ) |        | Saturation Current |         | Heat Rating Current    |
|---------------|---------------------|------------|--------|--------------------|---------|------------------------|
|               | L0(μH) ±20%<br>'@0A | Typical    | Max    | I sat (Amp)        | Typical | I rms (Amp)<br>Typical |
| MPIF0630-R15M | 0.15                | 1.55       | 2.30   | 41.00              |         | 30.00                  |
| MPIF0630-R22M | 0.22                | 1.60       | 2.50   | 35.00              |         | 25.00                  |
| MPIF0630-R47M | 0.47                | 4.00       | 4.50   | 20.00              |         | 18.00                  |
| MPIF0630-R68M | 0.68                | 4.75       | 5.30   | 19.00              |         | 16.00                  |
| MPIF0630-1R0M | 1.00                | 6.60       | 7.25   | 15.50              |         | 13.00                  |
| MPIF0630-1R5M | 1.50                | 13.20      | 16.00  | 18.00              |         | 12.50                  |
| MPIF0630-2R2M | 2.20                | 16.50      | 20.00  | 14.00              |         | 8.50                   |
| MPIF0630-3R3M | 3.30                | 24.50      | 35.00  | 12.00              |         | 7.00                   |
| MPIF0630-4R7M | 4.70                | 35.00      | 40.00  | 9.00               |         | 6.00                   |
| MPIF0630-5R6M | 5.60                | 36.00      | 42.00  | 7.00               |         | 5.70                   |
| MPIF0630-6R8M | 6.80                | 44.30      | 48.00  | 6.00               |         | 5.10                   |
| MPIF0630-8R2M | 8.20                | 60.00      | 64.90  | 6.00               |         | 5.00                   |
| MPIF0630-100M | 10.00               | 64.50      | 68.00  | 5.50               |         | 4.50                   |
| MPIF0630-150M | 15.00               | 103.00     | 115.00 | 4.60               |         | 3.10                   |
| MPIF0630-220M | 22.00               | 126.00     | 135.00 | 3.50               |         | 2.60                   |
| MPIF0630-330M | 33.00               | 250.00     | 270.00 | 3.00               |         | 2.00                   |

**Electrical characteristics for MPIF0650 series**

| P/N           | 100KHz 1.0V         | D.C.R (mΩ) |        | Saturation Current |         | Heat Rating Current    |
|---------------|---------------------|------------|--------|--------------------|---------|------------------------|
|               | L0(μH) ±20%<br>'@0A | Typical    | Max    | I sat (Amp)        | Typical | I rms (Amp)<br>Typical |
| MPIF0650-R22M | 0.22                | 1.10       | 1.30   | 35.00              |         | 30.00                  |
| MPIF0650-R47M | 0.47                | 3.20       | 3.80   | 21.00              |         | 20.00                  |
| MPIF0650-R56M | 0.56                | 3.40       | 3.90   | 18.00              |         | 18.00                  |
| MPIF0650-R68M | 0.68                | 3.90       | 4.20   | 16.00              |         | 16.00                  |
| MPIF0650-R82M | 0.82                | 4.60       | 4.90   | 15.00              |         | 14.00                  |
| MPIF0650-1R0M | 1.00                | 6.50       | 8.50   | 13.00              |         | 12.00                  |
| MPIF0650-1R5M | 1.50                | 7.00       | 8.50   | 12.00              |         | 10.00                  |
| MPIF0650-2R2M | 2.20                | 11.20      | 12.50  | 10.00              |         | 9.50                   |
| MPIF0650-3R3M | 3.30                | 20.00      | 22.00  | 9.00               |         | 8.50                   |
| MPIF0650-4R7M | 4.70                | 26.00      | 30.00  | 8.00               |         | 6.00                   |
| MPIF0650-6R8M | 6.80                | 36.50      | 41.00  | 7.00               |         | 5.50                   |
| MPIF0650-100M | 10.00               | 48.00      | 55.00  | 6.00               |         | 4.50                   |
| MPIF0650-150M | 15.00               | 77.00      | 85.00  | 4.00               |         | 3.10                   |
| MPIF0650-220M | 22.00               | 125.00     | 140.00 | 3.50               |         | 2.50                   |
| MPIF0650-330M | 33.00               | 150.00     | 200.00 | 3.00               |         | 2.30                   |
| MPIF0650-470M | 47.00               | 260.00     | 300.00 | 2.80               |         | 2.00                   |

# MOLDING POWER INDUCTOR.

## 一体成型系列

### ● PACKAGING SPECIFICATION :

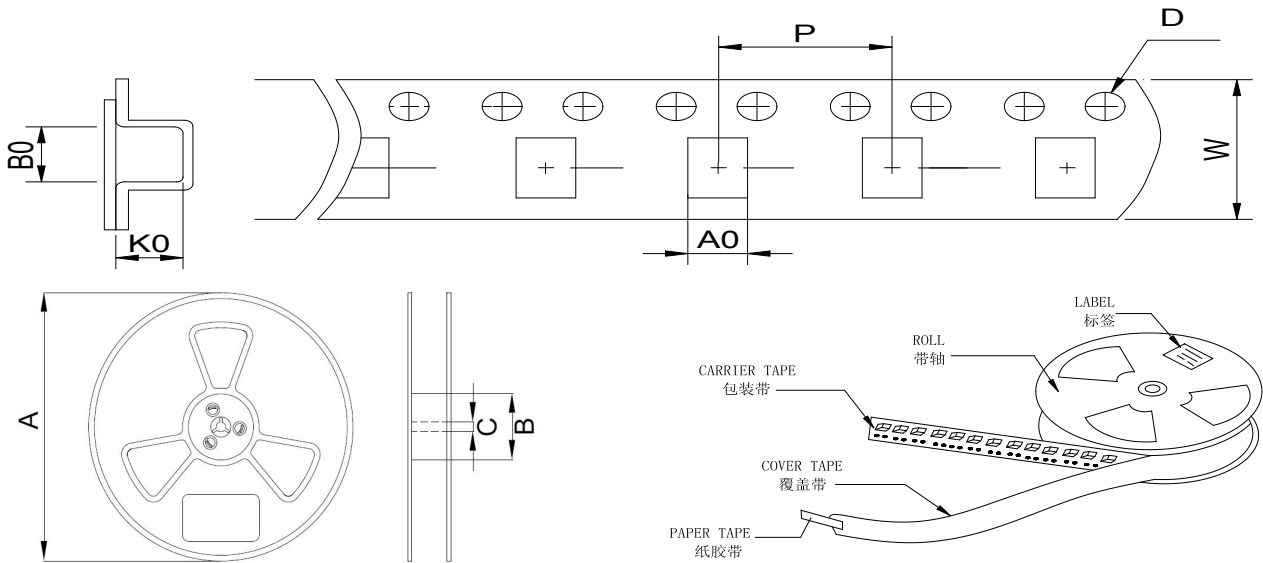

| Type       | Tape Dimension (mm) |      |      |     |     |      | Reel Dimension (mm) |     |    | Quantity (Pcs/Reel) |
|------------|---------------------|------|------|-----|-----|------|---------------------|-----|----|---------------------|
|            | W                   | A0   | B0   | K0  | DO  | P    | A                   | B   | C  |                     |
| MPIF201610 | 8.0                 | 1.8  | 2.2  | 1.1 | 1.5 | 4.0  | 178                 | 58  | 13 | 3000                |
| MPIF252010 | 8.0                 | 2.3  | 2.8  | 1.1 | 1.5 | 4.0  | 178                 | 58  | 13 | 3000                |
| MPIF252012 | 8.0                 | 2.3  | 2.8  | 1.3 | 1.5 | 4.0  | 178                 | 58  | 13 | 3000                |
| MPIF0302   | 12.0                | 3.6  | 3.9  | 2.2 | 1.5 | 8.0  | 330                 | 100 | 13 | 3000                |
| MPIF0402   | 12.0                | 4.8  | 4.8  | 2.0 | 1.5 | 8.0  | 330                 | 100 | 13 | 4000                |
| MPIF0502   | 12.0                | 5.5  | 6.0  | 2.0 | 1.5 | 8.0  | 330                 | 100 | 13 | 3000                |
| MPIF0503   | 12.0                | 5.5  | 6.0  | 3.0 | 1.5 | 8.0  | 330                 | 100 | 13 | 2000                |
| MPIF0603   | 16.0                | 6.8  | 7.3  | 3.0 | 1.5 | 12.0 | 330                 | 100 | 13 | 2000                |
| MPIF0604   | 16.0                | 6.8  | 7.3  | 4.0 | 1.5 | 12.0 | 330                 | 100 | 13 | 1000                |
| MPIF0605   | 16.0                | 6.8  | 7.3  | 5.0 | 1.5 | 12.0 | 330                 | 100 | 13 | 1000                |
| MPIF1004   | 24.0                | 10.6 | 11.6 | 4.0 | 1.5 | 16.0 | 330                 | 100 | 13 | 1000                |
| MPIF1005   | 24.0                | 10.6 | 11.6 | 5.0 | 1.5 | 16.0 | 330                 | 100 | 13 | 800                 |
| MPIF1350   | 24.0                | 13.1 | 14.1 | 5.0 | 1.5 | 20.0 | 330                 | 100 | 13 | 500                 |
| MPIF1360   | 24.0                | 13.1 | 14.1 | 6.0 | 1.5 | 20.0 | 330                 | 100 | 13 | 500                 |
| MPIF1365   | 24.0                | 13.1 | 14.1 | 6.6 | 1.5 | 20.0 | 330                 | 100 | 13 | 500                 |
| MPIF1707   | 32.0                | 17.5 | 18.0 | 7.3 | 1.5 | 24.0 | 330                 | 100 | 13 | 300                 |

**CKWLF Series****Features**

1. Small and Low profile inductor.
2. It corresponds to High current.
3. Simple and original magnetic shield
4. Durable structure against dropping impact.

**Applications**

1. LCD Displays
2. STB
3. LCD Monitor/TV
4. Smart meter
5. Tablet PC and other portable devices
6. DC/DC converters

**Description**

Current Rating:Based on the largest decline in ICP to 30%,  
and the temperature does not exceed 40°C.

**Shape & Dimensions & Land Patterns**

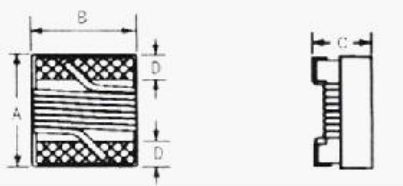
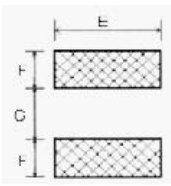
|  |        |         |        |  |          |          |          |
|--|--------|---------|--------|---|----------|----------|----------|
| TYPE   | A (mm) | B (mm)  | C (mm) | D (mm)  | E (Ref.) | F (Ref.) | G (Ref.) |
| CKWLF0603  | 1.8MAX | 1.2MAX  | 1.0MAX | 0.33TYP   | 0.64     | 1.92     | 1.02     |
| CKWLF0805  | 2.4MAX | 1.73MAX | 1.4MAX | 0.50TYP   | 0.96     | 3.00     | 1.78     |

**CKWLF0603 SERIES SPECIFICATION**

| Part Number       | Inductance(UH) | DCR (mΩ.) Max. | ISAT(A) | Teat Freq   |
|-------------------|----------------|----------------|---------|-------------|
| CKWLF0603-R27KC-P | 0.27           | 228            | 0.95    | 7.9MHZ/0.1V |
| CKWLF0603-R47KC-P | 0.47           | 228            | 0.92    | 7.9MHZ/0.1V |
| CKWLF0603-R68KC-P | 0.68           | 351            | 0.92    | 7.9MHZ/0.1V |
| CKWLF0603-R78KC-P | 0.78           | 364            | 0.80    | 7.9MHZ/0.1V |
| CKWLF0603-1R0KC-P | 1.00           | 416            | 0.75    | 7.9MHZ/0.1V |
| CKWLF0603-1R5KC-P | 1.50           | 520            | 0.65    | 7.9MHZ/0.1V |
| CKWLF0603-1R8KC-P | 1.80           | 559            | 0.55    | 7.9MHZ/0.1V |
| CKWLF0603-2R2KC-P | 2.20           | 728            | 0.60    | 7.9MHZ/0.1V |
| CKWLF0603-2R7KC-P | 2.70           | 806            | 0.50    | 7.9MHZ/0.1V |
| CKWLF0603-3R3KC-P | 3.30           | 910            | 0.45    | 7.9MHZ/0.1V |
| CKWLF0603-3R9KC-P | 3.90           | 1079           | 0.43    | 7.9MHZ/0.1V |
| CKWLF0603-4R7KC-P | 4.70           | 1261           | 0.40    | 7.9MHZ/0.1V |
| CKWLF0603-5R6KC-P | 5.60           | 1430           | 0.36    | 7.9MHZ/0.1V |

|                   |       |      |      |             |
|-------------------|-------|------|------|-------------|
| CKWLF0603-6R8KC-P | 6.80  | 1950 | 0.32 | 7.9MHZ/0.1V |
| CKWLF0603-8R2KC-P | 8.20  | 2184 | 0.30 | 7.9MHZ/0.1V |
| CKWLF0603-100KC-P | 10.00 | 2405 | 0.28 | 2.5MHZ/0.1V |
| CKWLF0603-120KC-P | 12.00 | 2964 | 0.26 | 2.5MHZ/0.1V |
| CKWLF0603-150KC-P | 15.00 | 4440 | 0.20 | 2.5MHZ/0.1V |
| CKWLF0603-180KC-P | 18.00 | 5040 | 0.19 | 2.5MHZ/0.1V |
| CKWLF0603-220KC-P | 22.00 | 5610 | 0.17 | 2.5MHZ/0.1V |
| CKWLF0603-270KC-P | 27.00 | 6760 | 0.14 | 2.5MHZ/0.1V |
| CKWLF0603-330KC-P | 33.00 | 8580 | 0.12 | 2.5MHZ/0.1V |
| CKWLF0603-470KC-P | 47.00 | 9750 | 0.10 | 2.5MHZ/0.1V |

**CHK**

Fixed inductors for surface mounting

**CKWLF0805 SERIES SPECIFICATION**

| Part Number       | Inductance(UH) | DCR (mΩ.) Max. | ISAT(A) | Teat Freq   |
|-------------------|----------------|----------------|---------|-------------|
| CKWLF0805-R10KC-P | 0.10           | 91             | 2.40    | 7.9MHZ/0.1V |
| CKWLF0805-R15KC-P | 0.15           | 104            | 1.90    | 7.9MHZ/0.1V |
| CKWLF0805-R22KC-P | 0.22           | 130            | 1.70    | 7.9MHZ/0.1V |
| CKWLF0805-R47KC-P | 0.47           | 156            | 1.40    | 7.9MHZ/0.1V |
| CKWLF0805-R68KC-P | 0.68           | 195            | 1.20    | 7.9MHZ/0.1V |
| CKWLF0805-R82KC-P | 0.82           | 195            | 1.10    | 7.9MHZ/0.1V |
| CKWLF0805-1R0KC-P | 1.00           | 169            | 1.10    | 7.9MHZ/0.1V |
| CKWLF0805-1R2KC-P | 1.20           | 208            | 0.96    | 7.9MHZ/0.1V |
| CKWLF0805-1R5KC-P | 1.50           | 221            | 0.92    | 7.9MHZ/0.1V |
| CKWLF0805-1R8KC-P | 1.80           | 260            | 0.86    | 7.9MHZ/0.1V |
| CKWLF0805-2R2KC-P | 2.20           | 286            | 0.74    | 7.9MHZ/0.1V |
| CKWLF0805-2R7KC-P | 2.70           | 325            | 0.68    | 7.9MHZ/0.1V |
| CKWLF0805-3R3KC-P | 3.30           | 364            | 0.62    | 7.9MHZ/0.1V |
| CKWLF0805-3R9KC-P | 3.90           | 494            | 0.58    | 7.9MHZ/0.1V |
| CKWLF0805-4R7KC-P | 4.70           | 559            | 0.52    | 7.9MHZ/0.1V |
| CKWLF0805-5R6KC-P | 5.60           | 560            | 0.48    | 7.9MHZ/0.1V |
| CKWLF0805-6R8KC-P | 6.80           | 884            | 0.42    | 7.9MHZ/0.1V |
| CKWLF0805-8R2KC-P | 8.20           | 949            | 0.40    | 7.9MHZ/0.1V |
| CKWLF0805-100KC-P | 10.00          | 1105           | 0.36    | 2.5MHZ/0.1V |
| CKWLF0805-120KC-P | 12.00          | 1170           | 0.34    | 2.5MHZ/0.1V |
| CKWLF0805-150KC-P | 15.00          | 1820           | 0.30    | 2.5MHZ/0.1V |
| CKWLF0805-180KC-P | 18.00          | 2015           | 0.28    | 2.5MHZ/0.1V |
| CKWLF0805-220KC-P | 22.00          | 2288           | 0.24    | 2.5MHZ/0.1V |
| CKWLF0805-270KC-P | 27.00          | 2600           | 0.22    | 2.5MHZ/0.1V |
| CKWLF0805-330KC-P | 33.00          | 3055           | 0.20    | 2.5MHZ/0.1V |
| CKWLF0805-390KC-P | 39.00          | 4355           | 0.18    | 2.5MHZ/0.1V |
| CKWLF0805-470KC-P | 47.00          | 5640           | 0.16    | 2.5MHZ/0.1V |

|                   |       |      |      |             |
|-------------------|-------|------|------|-------------|
| CKWLF0805-560KC-P | 56.00 | 6360 | 0.15 | 2.5MHZ/0.1V |
| CKWLF0805-680KC   | 68.00 | 7200 | 0.14 | 2.5MHZ/0.1V |

CHK

Fixed inductors for surface mounating

## CKWL

Shape & Dimensions & Land Patterns

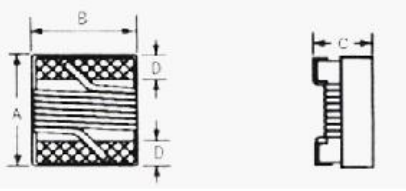
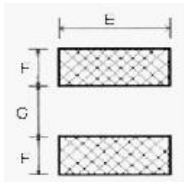
|  |         |         |         |         |  |          |          |
|---|---------|---------|---------|---------|--|----------|----------|
| TYPE  | A (mm)  | B (mm)  | C (mm)  | D (mm)  | E (Ref.)   | F (Ref.) | G (Ref.) |
| CKWL0402  | 1.3MAX  | 0.7MAX  | 0.7MAX  | 0.28TYP | 0.69   | 0.45     | 0.69     |
| CKWL0603  | 1.8MAX  | 1.12MAX | 1.02MAX | 0.35TYP | 1.02   | 0.64     | 0.64     |
| CKWL0805  | 2.29MAX | 1.73MAX | 1.55MAX | 0.57TYP | 1.78   | 1.02     | 0.76     |

CHK

Fixed inductors for surface mounating

### CKWL0402 SERIES SPECIFICATION

| Part Number    | Inductance(nH) | DCR (mΩ.) Max. | ISAT(A) | Teat Freq   |
|----------------|----------------|----------------|---------|-------------|
| CKWL0402-2N7JC | 2.70           | 120            | 0.64    | 250MHZ/0.1V |
| CKWL0402-3N6JC | 3.60           | 66             | 0.84    | 250MHZ/0.1V |
| CKWL0402-3N9JC | 3.90           | 66             | 0.84    | 250MHZ/0.1V |
| CKWL0402-4N1JC | 4.10           | 66             | 0.70    | 250MHZ/0.1V |
| CKWL0402-4N3JC | 4.30           | 91             | 0.70    | 250MHZ/0.1V |
| CKWL0402-4N7JC | 4.70           | 130            | 0.64    | 250MHZ/0.1V |
| CKWL0402-5N1JC | 5.10           | 83             | 0.80    | 250MHZ/0.1V |
| CKWL0402-5N6JC | 5.60           | 83             | 0.76    | 250MHZ/0.1V |
| CKWL0402-5N8JC | 6.80           | 83             | 0.76    | 250MHZ/0.1V |
| CKWL0402-6N2JC | 6.20           | 83             | 0.76    | 250MHZ/0.1V |
| CKWL0402-6N8JC | 6.80           | 83             | 0.68    | 250MHZ/0.1V |
| CKWL0402-7N5JC | 7.50           | 100            | 0.68    | 250MHZ/0.1V |
| CKWL0402-8N2JC | 8.20           | 100            | 0.48    | 250MHZ/0.1V |
| CKWL0402-8N7JC | 8.70           | 200            | 0.68    | 250MHZ/0.1V |
| CKWL0402-9N0JC | 9.00           | 100            | 0.68    | 250MHZ/0.1V |
| CKWL0402-9N1JC | 9.10           | 100            | 0.48    | 250MHZ/0.1V |
| CKWL0402-9N5JC | 9.50           | 200            | 0.64    | 250MHZ/0.1V |
| CKWL0402-12NJC | 12.00          | 120            | 0.44    | 250MHZ/0.1V |
| CKWL0402-13NJC | 13.00          | 210            | 0.56    | 250MHZ/0.1V |
| CKWL0402-15NJC | 15.00          | 170            | 0.56    | 250MHZ/0.1V |
| CKWL0402-16NJC | 16.00          | 220            | 0.42    | 250MHZ/0.1V |
| CKWL0402-18NJC | 18.00          | 230            | 0.48    | 250MHZ/0.1V |
| CKWL0402-19NJC | 19.00          | 240            | 0.42    | 250MHZ/0.1V |

|                |       |      |      |             |
|----------------|-------|------|------|-------------|
| CKWL0402-20NJC | 20.00 | 250  | 0.40 | 250MHZ/0.1V |
| CKWL0402-22NJC | 22.00 | 300  | 0.40 | 250MHZ/0.1V |
| CKWL0402-23NJC | 23.00 | 300  | 0.40 | 250MHZ/0.1V |
| CKWL0402-27NJC | 27.00 | 300  | 0.40 | 250MHZ/0.1V |
| CKWL0402-30NJC | 30.00 | 300  | 0.32 | 250MHZ/0.1V |
| CKWL0402-33NJC | 33.00 | 564  | 0.20 | 250MHZ/0.1V |
| CKWL0402-36NJC | 36.00 | 564  | 0.32 | 250MHZ/0.1V |
| CKWL0402-39NJC | 39.00 | 624  | 0.20 | 250MHZ/0.1V |
| CKWL0402-40NJC | 40.00 | 624  | 0.32 | 250MHZ/0.1V |
| CKWL0402-43NJC | 43.00 | 810  | 0.10 | 250MHZ/0.1V |
| CKWL0402-47NJC | 47.00 | 930  | 0.15 | 250MHZ/0.1V |
| CKWL0402-51NJC | 51.00 | 920  | 0.10 | 250MHZ/0.1V |
| CKWL0402-56NJC | 56.00 | 970  | 0.10 | 250MHZ/0.1V |
| CKWL0402-68NJC | 68.00 | 1120 | 0.10 | 250MHZ/0.1V |

**CHK** Fixed inductors for surface mounating

**CKWL0805 SERIES SPECIFICATION**

| Part Number    | Inductance(mH) | DCR (mΩ.) Max. | ISAT(A) | Teat Freq   |
|----------------|----------------|----------------|---------|-------------|
| CKWL0805-2N8JC | 2.80           | 60             | 0.80.   | 250MHZ/0.1V |
| CKWL0805-3N3JC | 3.30           | 80             | 0.60    | 250MHZ/0.1V |
| CKWL0805-6N2JC | 6.20           | 110            | 0.60    | 250MHZ/0.1V |
| CKWL0805-6N8JC | 6.80           | 110            | 0.60    | 250MHZ/0.1V |
| CKWL0805-8N7JC | 8.70           | 210            | 0.40    | 250MHZ/0.1V |
| CKWL0805-10NJC | 10.00          | 100            | 0.60    | 250MHZ/0.1V |
| CKWL0805-15NJC | 15.0           | 170            | 0.60    | 250MHZ/0.1V |
| CKWL0805-18NJC | 18.0           | 200            | 0.60    | 250MHZ/0.1V |
| CKWL0805-20NJC | 20.0           | 220            | 0.50    | 250MHZ/0.1V |
| CKWL0805-22NJC | 22.0           | 220            | 0.50    | 250MHZ/0.1V |
| CKWL0805-24NJC | 24.0           | 220            | 0.50    | 250MHZ/0.1V |
| CKWL0805-27NJC | 27.0           | 250            | 0.50    | 250MHZ/0.1V |
| CKWL0805-33NJC | 33.0           | 270            | 0.50    | 250MHZ/0.1V |
| CKWL0805-39NJC | 39.0           | 290            | 0.50    | 250MHZ/0.1V |
| CKWL0805-43NJC | 43.0           | 340            | 0.50    | 250MHZ/0.1V |
| CKWL0805-47NJC | 47.0           | 310            | 0.50    | 200MHZ/0.1V |
| CKWL0805-56NJC | 56.0           | 320            | 0.50    | 200MHZ/0.1V |
| CKWL0805-68NJC | 68.0           | 380            | 0.50    | 200MHZ/0.1V |
| CKWL0805-72NJC | 72.0           | 400            | 0.50    | 150MHZ/0.1V |
| CKWL0805-82NJC | 82.0           | 420            | 0.40    | 150MHZ/0.1V |
| CKWL0805-91NJC | 91.0           | 480            | 0.40    | 150MHZ/0.1V |
| CKWL0805-R10JC | 100            | 460            | 0.40    | 150MHZ/0.1V |

|                |      |      |      |             |
|----------------|------|------|------|-------------|
| CKWL0805-R11JC | 110  | 480  | 0.40 | 150MHZ/0.1V |
| CKWL0805-R12JC | 120  | 510  | 0.40 | 150MHZ/0.1V |
| CKWL0805-R15JC | 150  | 560  | 0.40 | 100MHZ/0.1V |
| CKWL0805-R16JC | 160  | 600  | 0.40 | 100MHZ/0.1V |
| CKWL0805-R18JC | 180  | 640  | 0.40 | 100MHZ/0.1V |
| CKWL0805-R20JC | 200  | 660  | 0.40 | 100MHZ/0.1V |
| CKWL0805-R22JC | 220  | 4400 | 0.40 | 100MHZ/0.1V |
| CKWL0805-R24JC | 240  | 1000 | 0.35 | 100MHZ/0.1V |
| CKWL0805-R25JC | 250  | 1000 | 0.35 | 100MHZ/0.1V |
| CKWL0805-R27JC | 270  | 1000 | 0.35 | 100MHZ/0.1V |
| CKWL0805-R30JC | 300  | 1200 | 0.33 | 100MHZ/0.1V |
| CKWL0805-R33JC | 330  | 1400 | 0.31 | 100MHZ/0.1V |
| CKWL0805-R36JC | 360  | 1450 | 0.30 | 100MHZ/0.1V |
| CKWL0805-R39JC | 390  | 1500 | 0.29 | 100MHZ/0.1V |
| CKWL0805-R43JC | 430  | 1700 | 0.23 | 50MHZ/0.1V  |
| CKWL0805-R47JC | 470  | 1700 | 0.50 | 50MHZ/0.1V  |
| CKWL0805-R56JC | 560  | 1900 | 0.23 | 25MHZ/0.1V  |
| CKWL0805-R62JC | 620  | 1950 | 0.20 | 25MHZ/0.1V  |
| CKWL0805-R68JC | 680  | 2050 | 0.19 | 25MHZ/0.1V  |
| CKWL0805-R75JC | 750  | 2100 | 0.18 | 25MHZ/0.1V  |
| CKWL0805-R82JC | 820  | 2300 | 0.18 | 25MHZ/0.1V  |
| CKWL0805-1R0JC | 1000 | 2500 | 0.17 | 25MHZ/0.1V  |
| CKWL0805-1R2JC | 1200 | 2500 | 0.17 | 7.9MHZ/0.1V |

**CHK** Fixed inductors for surface mounating

**CKWL0603 SERIES SPECIFICATION**

| Part Number    | Inductance(UH) | DCR (mΩ.) Max. | ISAT(A) | Teat Freq   |
|----------------|----------------|----------------|---------|-------------|
| CKWL0603-1N8KC | 1.8            | 43             | 1.00    | 250MHZ/0.1V |
| CKWL0603-3N9JC | 3.9            | 59             | 0.85    | 250MHZ/0.1V |
| CKWL0603-4N7KC | 4.7            | 65             | 0.80    | 250MHZ/0.1V |
| CKWL0603-5N1JC | 5.1            | 130            | 0.60    | 250MHZ/0.1V |
| CKWL0603-6N8JC | 6.8            | 95             | 0.70    | 250MHZ/0.1V |
| CKWL0603-7N5JC | 7.5            | 95             | 0.70    | 250MHZ/0.1V |
| CKWL0603-8N2JC | 8.2            | 95             | 0.70    | 250MHZ/0.1V |
| CKWL0603-9N1JC | 9.1            | 120            | 0.62    | 250MHZ/0.1V |
| CKWL0603-9N5JC | 9.5            | 160            | 0.54    | 250MHZ/0.1V |
| CKWL0603-10NJC | 10.0           | 130            | 0.61    | 250MHZ/0.1V |
| CKWL0603-11NJC | 11.0           | 130            | 0.60    | 250MHZ/0.1V |
| CKWL0603-12NJC | 12.0           | 130            | 0.60    | 250MHZ/0.1V |
| CKWL0603-13NJC | 13.0           | 130            | 0.60    | 250MHZ/0.1V |
| CKWL0603-16NJC | 16.0           | 150            | 0.55    | 250MHZ/0.1V |

|                |       |      |      |             |
|----------------|-------|------|------|-------------|
| CKWL0603-18NJC | 18.0  | 150  | 0.55 | 250MHZ/0.1V |
| CKWL0603-20NJC | 20.0  | 150  | 0.55 | 250MHZ/0.1V |
| CKWL0603-22NJC | 22.0  | 190  | 0.49 | 250MHZ/0.1V |
| CKWL0603-24NJC | 24.0  | 190  | 0.49 | 250MHZ/0.1V |
| CKWL0603-27NJC | 27.0  | 190  | 0.49 | 250MHZ/0.1V |
| CKWL0603-30NJC | 30.0  | 210  | 0.47 | 250MHZ/0.1V |
| CKWL0603-33NJC | 33.0  | 210  | 0.47 | 250MHZ/0.1V |
| CKWL0603-36NJC | 36.0  | 220  | 0.46 | 250MHZ/0.1V |
| CKWL0603-39NJC | 39.0  | 220  | 0.46 | 250MHZ/0.1V |
| CKWL0603-43NJC | 43.0  | 270  | 0.40 | 250MHZ/0.1V |
| CKWL0603-47NJC | 47.0  | 270  | 0.40 | 200MHZ/0.1V |
| CKWL0603-51NJC | 51.0  | 220  | 0.39 | 200MHZ/0.1V |
| CKWL0603-56NJC | 56.0  | 250  | 0.36 | 200MHZ/0.1V |
| CKWL0603-62NJC | 62.0  | 280  | 0.25 | 200MHZ/0.1V |
| CKWL0603-68NJC | 68.0  | 280  | 0.25 | 200MHZ/0.1V |
| CKWL0603-72NJC | 72.0  | 430  | 0.30 | 150MHZ/0.1V |
| CKWL0603-91NJC | 91.0  | 520  | 0.30 | 150MHZ/0.1V |
| CKWL0603-R10JC | 100.0 | 660  | 0.26 | 150MHZ/0.1V |
| CKWL0603-R11JC | 110.0 | 730  | 0.25 | 150MHZ/0.1V |
| CKWL0603-R12JC | 120.0 | 750  | 0.24 | 150MHZ/0.1V |
| CKWL0603-R15JC | 150.0 | 4420 | 0.20 | 150MHZ/0.1V |
| CKWL0603-R18JC | 180.0 | 1380 | 0.18 | 100MHZ/0.1V |
| CKWL0603-R20JC | 200.0 | 1900 | 0.15 | 100MHZ/0.1V |
| CKWL0603-R22JC | 220.0 | 2100 | 0.14 | 100MHZ/0.1V |
| CKWL0603-R27JC | 270.0 | 3000 | 0.12 | 100MHZ/0.1V |
| CKWL0603-R33JC | 330.0 | 4200 | 0.10 | 100MHZ/0.1V |
| CKWL0603-R39JC | 390.0 | 4500 | 0.10 | 100MHZ/0.1V |
| CKWL0603-R47JC | 470.0 | 5700 | 0.09 | 100MHZ/0.1V |

Tape Dimensions

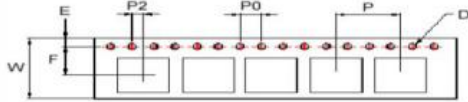

Reel Dimensions

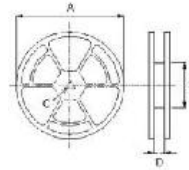

| TYPE                    | Dimensions(mm) |    |     |      |     |    |    | Reel Dimensions |       |       |       | Quantity |
|-------------------------|----------------|----|-----|------|-----|----|----|-----------------|-------|-------|-------|----------|
|                         | W              | P  | D   | E    | F   | PO | P2 | A(mm)           | B(mm) | C(mm) | D(mm) | pcs/Reel |
| CKWL0805/<br>CK WLF0805 | 8              | 4  | 1.5 | 1.75 | 3.5 | 4  | 2  | 178             | 60    | 13    | 8.4   | 2000     |
| CKWL0603/<br>CK WLF0603 | 8              | 4  | 1.5 | 1.75 | 3.5 | 4  | 2  | 178             | 60    | 13    | 8.4   | 4000     |
| CKWL0402                | 8              | 4  | 1.5 | 1.75 | 3.5 | 4  | 2  | 178             | 60    | 13    | 8.4   | 5000     |
| CKNR201610              | 8              | 4  | 1.5 | 1.75 | 3.5 | 4  | 2  | 178             | 60    | 13    | 8.4   | 2000     |
| CKNRS201610             | 8              | 4  | 1.5 | 1.75 | 3.5 | 4  | 2  | 178             | 60    | 13    | 8.4   | 2000     |
| CKNR252008              | 8              | 4  | 1.5 | 1.75 | 3.5 | 4  | 2  | 178             | 60    | 13    | 8.4   | 2000     |
| CKNR252010              | 8              | 4  | 1.5 | 1.75 | 3.5 | 4  | 2  | 178             | 60    | 13    | 8.4   | 2000     |
| CKNRS252010             | 8              | 4  | 1.5 | 1.75 | 3.5 | 4  | 2  | 178             | 60    | 13    | 8.4   | 2000     |
| CKNR252012              | 8              | 4  | 1.5 | 1.75 | 3.5 | 4  | 2  | 178             | 60    | 13    | 8.4   | 2000     |
| CKNRS252012             | 8              | 4  | 1.5 | 1.75 | 3.5 | 4  | 2  | 178             | 60    | 13    | 8.4   | 2000     |
| CKNR3010                | 8              | 4  | 1.5 | 1.75 | 5.5 | 4  | 2  | 178             | 60    | 13    | 8.4   | 2000     |
| CKNRS3010               | 12             | 8  | 1.5 | 1.75 | 5.5 | 4  | 2  | 330             | 100   | 13    | 12.5  | 4000     |
| CKNR3012                | 8              | 4  | 1.5 | 1.75 | 5.5 | 4  | 2  | 178             | 60    | 13    | 8.4   | 2000     |
| CKNR3015                | 8              | 4  | 1.5 | 1.75 | 5.5 | 4  | 2  | 178             | 60    | 13    | 8.4   | 2000     |
| CKNR4010                | 12             | 8  | 1.5 | 1.75 | 5.5 | 4  | 2  | 330             | 100   | 13    | 12.5  | 4500     |
| CKNRS4010               | 12             | 8  | 1.5 | 1.75 | 5.5 | 4  | 2  | 330             | 100   | 13    | 12.5  | 4500     |
| CKNR4012                | 12             | 8  | 1.5 | 1.75 | 5.5 | 4  | 2  | 330             | 100   | 13    | 12.5  | 4500     |
| CKNRS4012               | 12             | 8  | 1.5 | 1.75 | 5.5 | 4  | 2  | 330             | 100   | 13    | 12.5  | 4500     |
| CKNR4015                | 12             | 8  | 1.5 | 1.75 | 5.5 | 4  | 2  | 330             | 100   | 13    | 12.5  | 3000     |
| CKNR4018                | 12             | 8  | 1.5 | 1.75 | 5.5 | 4  | 2  | 330             | 100   | 13    | 12.5  | 3000     |
| CKNR4020                | 12             | 8  | 1.5 | 1.75 | 5.5 | 4  | 2  | 330             | 100   | 13    | 12.5  | 3000     |
| CKNR4030                | 12             | 8  | 1.5 | 1.75 | 5.5 | 4  | 2  | 330             | 100   | 13    | 12.5  | 2000     |
| CKNR5012                | 12             | 8  | 1.5 | 1.75 | 5.5 | 4  | 2  | 330             | 100   | 13    | 12.5  | 4500     |
| CKNR5020                | 12             | 8  | 1.5 | 1.75 | 5.5 | 4  | 2  | 330             | 100   | 13    | 12.5  | 2500     |
| CKNRS5040               | 12             | 8  | 1.5 | 1.75 | 5.5 | 4  | 2  | 330             | 100   | 13    | 12.5  | 1500     |
| CKNR6010                | 16             | 8  | 1.5 | 1.75 | 7.5 | 4  | 2  | 178             | 60    | 13    | 16.5  | 1000     |
| CKNR6012                | 16             | 8  | 1.5 | 1.75 | 7.5 | 4  | 2  | 178             | 60    | 13    | 16.5  | 1000     |
| CKNR6020                | 16             | 8  | 1.5 | 1.75 | 7.5 | 4  | 2  | 330             | 100   | 13    | 16.5  | 2500     |
| CKNR6028                | 16             | 8  | 1.5 | 1.75 | 7.5 | 4  | 2  | 330             | 100   | 13    | 16.5  | 2000     |
| CKNR6045                | 16             | 8  | 1.5 | 1.75 | 7.5 | 4  | 2  | 330             | 100   | 13    | 16.5  | 1000     |
| CKNR8040                | 16             | 12 | 1.5 | 1.75 | 7.5 | 4  | 2  | 330             | 100   | 13    | 16.5  | 1000     |

还有更多为客户定做的插件电感、磁环电感、工模电感、变压器等

专业的功率电感供应商，值得信赖



# 深圳市今诚电子有限公司