

贴片功率电感
SMD POWER INDUCTOR

Type Name: CKDRB Series



Dimensions/外形尺寸图(Unit:mm)

Land patterns/贴装尺寸

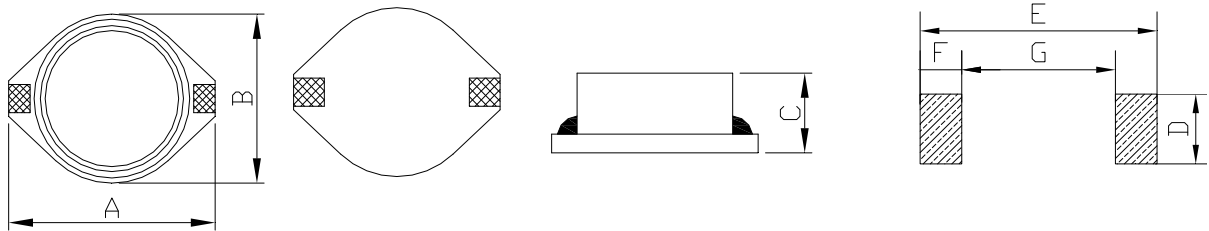

Shape and Size:(Dimensions are in mm)

Type Name/型名	A	B	C	D	E	F	G
CKDRB1205	12.92MAX	9.4MAX	5.08MAX	2.79REF	13.21REF	2.92REF	7.37REF
CKDRB1806	18.7MAX	15.3MAX	7.5MAX	2.79REF	18.7REF	3.0REF	12.7REF

Specifications/规格

TYPE NAME: CKDRB1806				
Part No./品名	Inductance/ 电感值 (μ H)	Test Condition/ 测试条件	D.C.R./直流阻抗 (m Ω)MAX.	Saturation Current/ 饱和电流(A) MAX.
CKDRB1806-100MC	10 \pm 20%	1KHz,1V	26	4.00
CKDRB1806-150MC	15 \pm 20%	1KHz,1V	33	3.60
CKDRB1806-220MC	22 \pm 20%	1KHz,1V	46	3.15
CKDRB1806-330MC	33 \pm 20%	1KHz,1V	71	2.80
CKDRB1806-470MC	47 \pm 20%	1KHz,1V	106	2.45
CKDRB1806-680MC	68 \pm 20%	1KHz,1V	128	2.00
CKDRB1806-101MC	100 \pm 20%	1KHz,1V	200	1.70
CKDRB1806-151MC	150 \pm 20%	1KHz,1V	294	1.35
CKDRB1806-221MC	220 \pm 20%	1KHz,1V	406	1.15
CKDRB1806-331MC	330 \pm 20%	1KHz,1V	600	0.90
CKDRB1806-471MC	470 \pm 20%	1KHz,1V	840	0.75
CKDRB1806-681MC	680 \pm 20%	1KHz,1V	1280	0.66
CKDRB1806-102KC	1000 \pm 10%	1KHz,1V	1500	0.55

贴片功率电感
SMD POWER INDUCTOR

TYPE NAME: CKDRB1205

Part No./品名	Inductance/ 电感值 (μ H)	Test Condition/ 测试条件	D.C.R./直流阻抗(m Ω)MAX.	Saturation Current/ 饱和电流(A) MAX.
CKDRB1205-1R0MC	1.0 \pm 20%	100KHz,1V	13.74	5.00
CKDRB1205-1R5MC	1.5 \pm 20%	100KHz,1V	15.72	4.50
CKDRB1205-2R2MC	2.2 \pm 20%	100KHz,1V	22.65	3.10
CKDRB1205-3R3MC	3.3 \pm 20%	100KHz,1V	30.60	2.90
CKDRB1205-4R7MC	4.7 \pm 20%	100KHz,1V	42.60	2.50
CKDRB1205-6R8MC	6.8 \pm 20%	100KHz,1V	60.84	2.20
CKDRB1205-100MC	10 \pm 20%	1KHz,1V	81.50	2.10
CKDRB1205-120MC	12 \pm 20%	1KHz,1V	102.0	1.80
CKDRB1205-150MC	15 \pm 20%	1KHz,1V	117.8	1.70
CKDRB1205-180MC	18 \pm 20%	1KHz,1V	138.0	1.60
CKDRB1205-220MC	22 \pm 20%	1KHz,1V	177.3	1.42
CKDRB1205-270MC	27 \pm 20%	1KHz,1V	231	1.30
CKDRB1205-330MC	33 \pm 20%	1KHz,1V	296	1.20
CKDRB1205-390MC	39 \pm 20%	1KHz,1V	330	1.10
CKDRB1205-470MC	47 \pm 20%	1KHz,1V	380	1.00
CKDRB1205-560MC	56 \pm 20%	1KHz,1V	463	0.90
CKDRB1205-680MC	68 \pm 20%	1KHz,1V	564	0.82
CKDRB1205-820MC	82 \pm 20%	1KHz,1V	697	0.75
CKDRB1205-101MC	100 \pm 20%	1KHz,1V	792	0.68
CKDRB1205-121MC	120 \pm 20%	1KHz,1V	913	0.60
CKDRB1205-151MC	150 \pm 20%	1KHz,1V	1084	0.55
CKDRB1205-181MC	180 \pm 20%	1KHz,1V	1387	0.50
CKDRB1205-221MC	220 \pm 20%	1KHz,1V	1731	0.46
CKDRB1205-271MC	270 \pm 20%	1KHz,1V	1986	0.40
CKDRB1205-331MC	330 \pm 20%	1KHz,1V	2565	0.35
CKDRB1205-391MC	390 \pm 20%	1KHz,1V	2909	0.33

※ The saturation current when the inductance decreases to 75% of initial value. (Ta=25°C)